

ACCESSORY SETUP INSTRUCTION

REAR BUMPER ASSEMBLY -- PN 9DS#-801200-6000

VALID FOR: MY2020 and Newer CFORCE 600 / 625 & CFORCE 600 TOURING / 625 TOURING

BEFORE YOU BEGIN: Read and understand the instructions before starting any work. Make sure that all parts are ready and that you have all the tools required for assembly.

NOTE: CFMOTO shall not be liable for any damage caused by incorrect assembly. CFMOTO recommends that all original accessories be assembled by an authorized CFMOTO dealer.

Before assembly, park the vehicle on a flat surface, put the transmission gear into Park (P) and turn off the key switch.

Zhejiang CFMOTO Power Co., Ltd. All rights reserved. Reproduction of this document, even in part, as well as copying of all kinds, is permitted only with the express written permission of the copyright owner.

MEANING OF SYMBOLS

 - Indicates information with more details or tips.

 - Indicates information of warning or danger.

PARTS LIST:

S/N	PART NAME	PART NUMBER	QTY.	REMARK
1	REAR BUMPER ASSEMBLY	9DS#-801200-6000	1	
2	REAR BUMPER	9DS#-801310-6000	1	
3	PLUG 38	9DS#-801401-6000	4	
4	WASHER 6x12x1.6	30300-060172	2	
5	SCREW M6x12	30102-060012870	2	

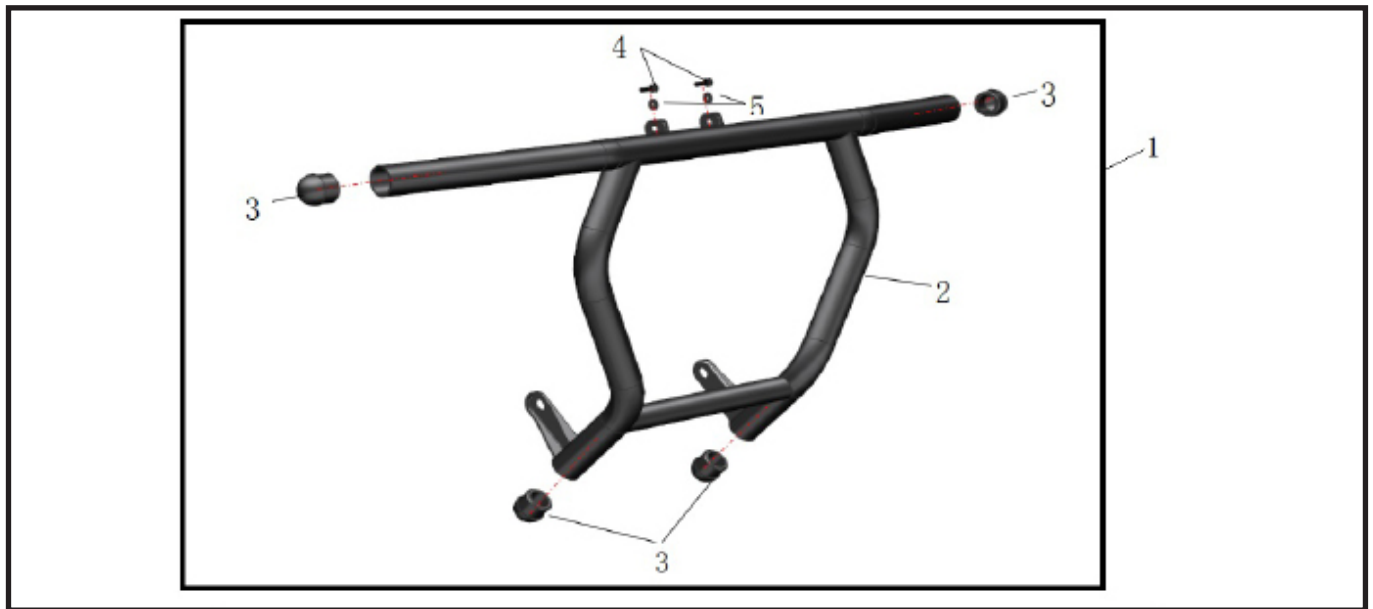

TOOL LIST:

Item	Description	QTY.	REMARK
1	SOCKET WRENCH	1	Recommended tools
2	SOCKET EXTENSION	1	
3	13mm SOCKET	1	
4	RUBBER HAMMER	1	
5	5mm INNER HEX	1	
6	PROTECTIVE GLOVES	1	

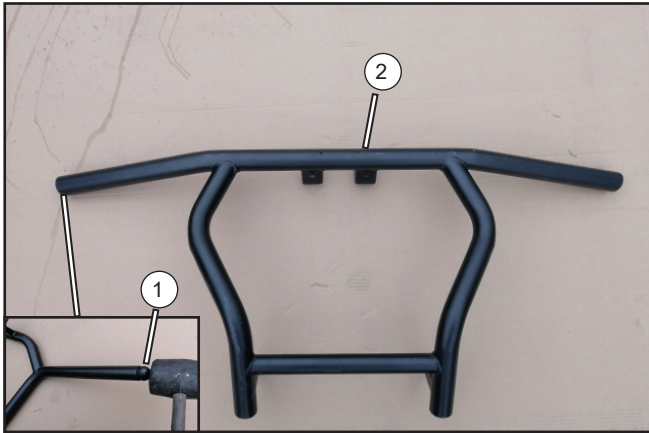

// Use a rubber hammer to install the plugs (3) into the rear bumper (2).

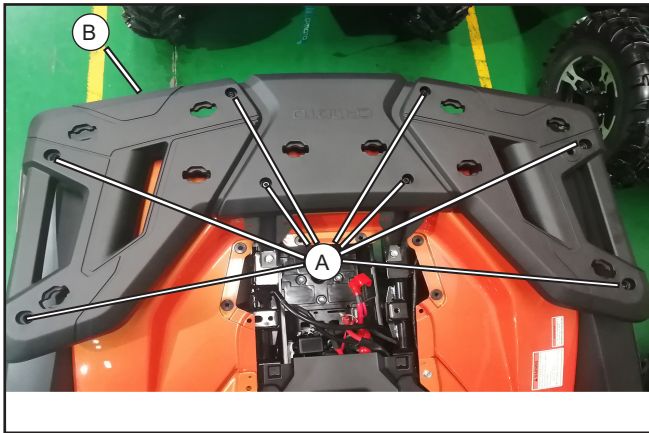

// Loosen the screws (A) and remove the rear rack cover (B).

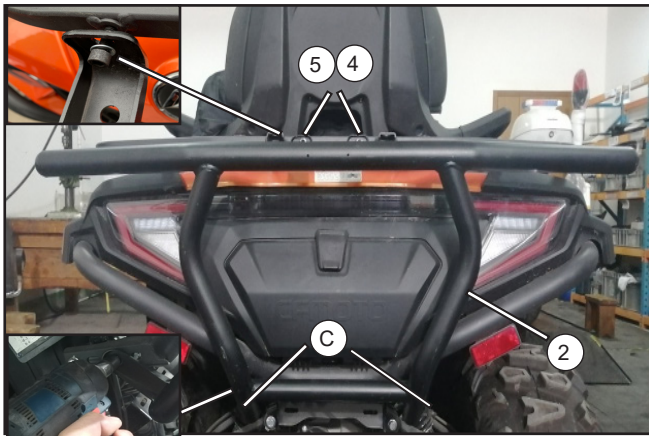

Install the rear bumper assembly:

- // Remove the M8 bottom bumper bolts (C).
- // Place washers (5) on hex screws (4). Align the upper bumper mount to the rear rack mounting holes, then install the M6x12 bolts (3,4). *Do not fully tighten bolts at this time.*
- // Align the lower bumper mount to the mounting holes, then install the previously removed M8 bolts (C).
- // Tighten all bolts to the specified torque value.

BOLT	M8	300006-080016810	30-45N.m
WASHER	6X12X1.6	30300-060172	/
INNER HEX SCREW	M6x12	30102-060012870	8-10N.m

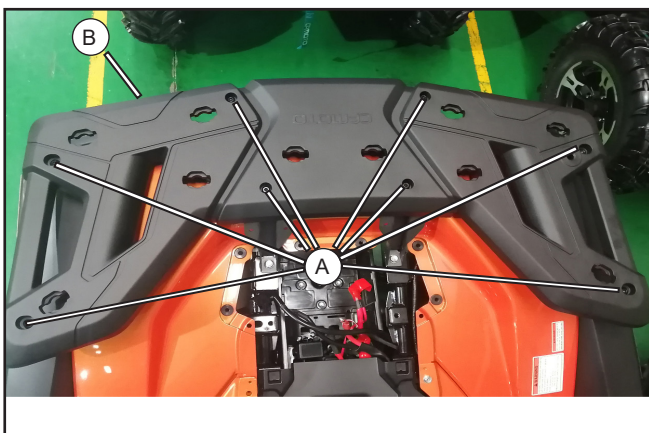

// Install the rear rack cover (B) and previously removed screws (A). Hand-tighten the screws sufficiently, using care not to over-tighten.