

ACCESSORY SETUP INSTRUCTIONS

SKID PLATE PN: 6WWV-808500-5000

VALID FOR: MY2022 and later IBEX 800 SPORT / TOURING

BEFORE YOU BEGIN: Read and understand the instructions before starting any work. Make sure that all parts are ready and that you have all the tools required for assembly.

NOTE: CFMOTO shall not be liable for any damage caused by incorrect assembly. CFMOTO recommends that all original accessories be assembled by an authorized CFMOTO dealer.

Before assembly, park the vehicle on a flat surface and turn off the vehicle.

Zhejiang CFMOTO Power Co., Ltd. All rights reserved. Reproduction of this document, even in part, as well as copying of all kinds, is permitted only with the express written permission of the copyright owner.

MEANING OF SYMBOLS

i - Indicates information with more details or tips.

! - Indicates information of warning or danger.

PART LIST:

S/N	PART NAME	PART NUMBER	QTY.	DESCRIPTION
1	SKID PLATE ASSEMBLY	6WWV-808500-5000	1	Picture is for structure reference only.
2	SKID PLATE	--	1	
3	INNER BRACKET	--	1	
4	SILENT BLOCK, Ø25x15mm M6	--	2	
5	SILENT BLOCK, Ø25x30mm M6	--	2	
6	SCREW, DIN 7380-2 M6x8mm	--	2	
7	SCREW, DIN 7991 M6x10mm	--	10	

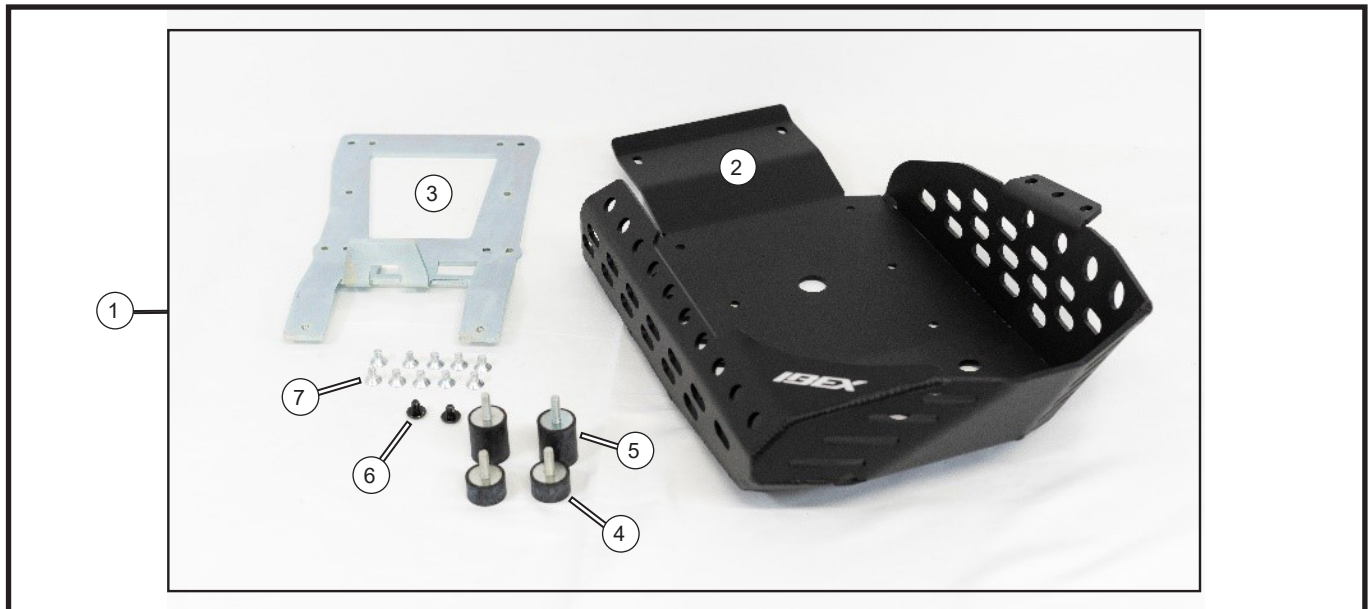

TOOL LIST:

ITEM	DESCRIPTION	REMARK
1	4mm, 5mm, 6mm ALLEN WRENCHES	Recommended Tools
2	10mm SOCKET & WRENCH	
3	PROTECTIVE GLOVES	

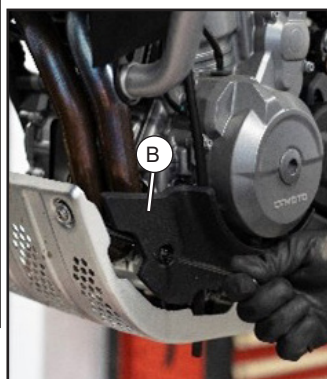
WORK

// Remove the original plastic panels on the right (A) and left (B) sides. Discard them and their mounting screws.



// Remove the original skid plate. Discard it and its mounting screws.

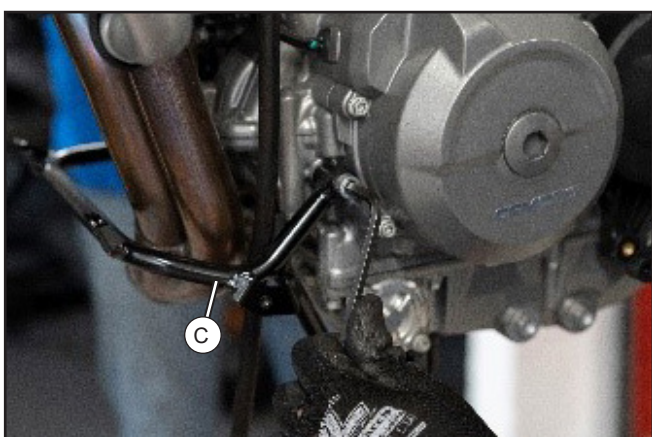

// Remove the original front bracket (C). Discard it and its mounting screws.

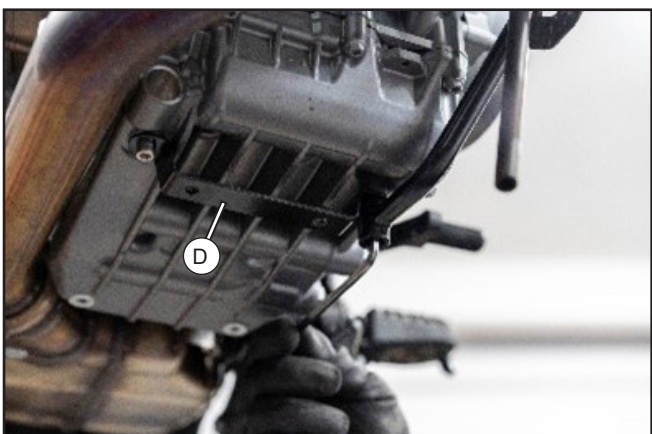

// Remove the original lower bracket (D). Discard it and its mounting screws.

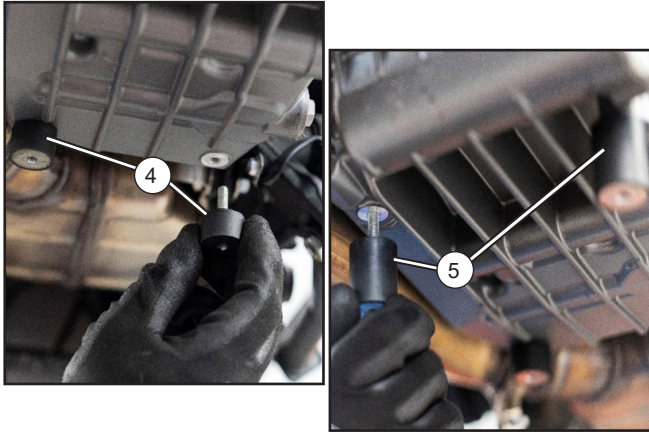
WORK

- // Install the short silent blocks (4) into the rear threaded holes of the engine oil pan.
- // Install the long silent blocks (5) into the front threaded holes of the engine oil pan.

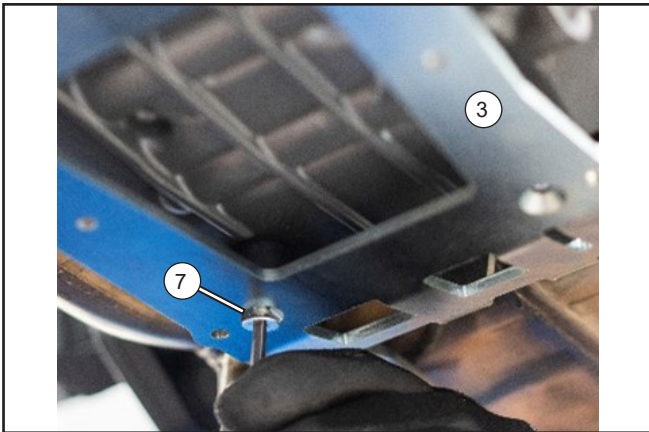

- // Fasten the inner bracket (3) to the installed silent blocks using 4 of the supplied M6x10mm screws (7).

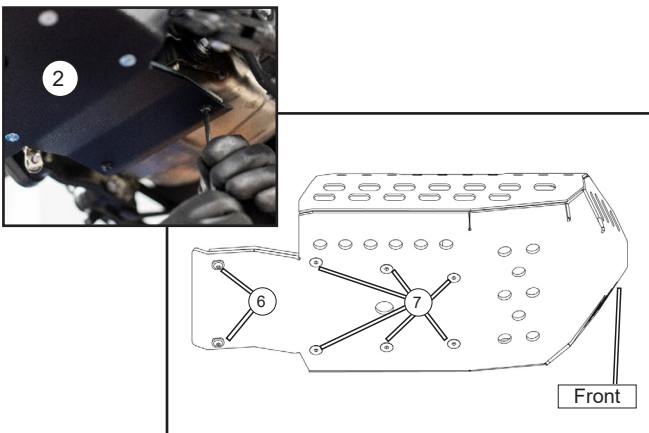

- // Install the skid plate (2) using the 8 threaded holes of the inner bracket. Use 6 of the supplied M6x10mm screws (7) and the 2 supplied M6x8mm screws (6), which go in the rearmost holes.

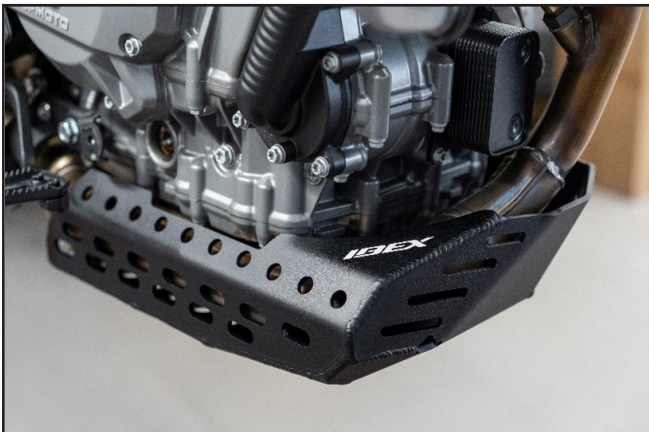

- // Assembly is complete.