



ACCESSORY SETUP INSTRUCTION

TOP CASE, SILVER -- PN 6WWV-803000-5000

VALID FOR: MY2023 and later Ibex 800 S, Ibex 800 T

This assembly instruction takes the silver box as an example

BEFORE YOU BEGIN: Read and understand the instructions before starting any work. Make sure that all parts are ready and that you have all the tools required for assembly.

NOTE: CFMOTO shall not be liable for any damage caused by incorrect assembly. CFMOTO recommends that all original accessories be assembled by an authorized CFMOTO dealer.

Before assembly, park the vehicle on a flat surface, and turn off the key switch.

Zhejiang CFMOTO Power Co., Ltd. All rights reserved. Reproduction of this document, even in part, as well as copying of all kinds, is permitted only with the express written permission of the copyright owner.

MEANING OF SYMBOLS

 - Indicates information with more details or tips.

 - Indicates information of warning or danger.

PARTS LIST:

ITEM	PART NAME	PART NUMBER	QTY.	REMARK
1	TAIL BOX ASSY	6WWV-803000-5000	1	
2	TAIL BOX	6WWV-803100-5000	1	
3	TAIL BOX TRAY ASS	6WW5-220400-5000	1	
4	INNER HEX SUNK BOLT M8×80	6WWV-803200-5000-20	2	
5	INNER HEX SUNK BOLT M8×40	6WWV-803200-5000-21	2	
6	FRONT SUPPORTER	6WW5-140006-5000	2	
7	REAR SUPPORTER	6WW5-140007-5000	2	

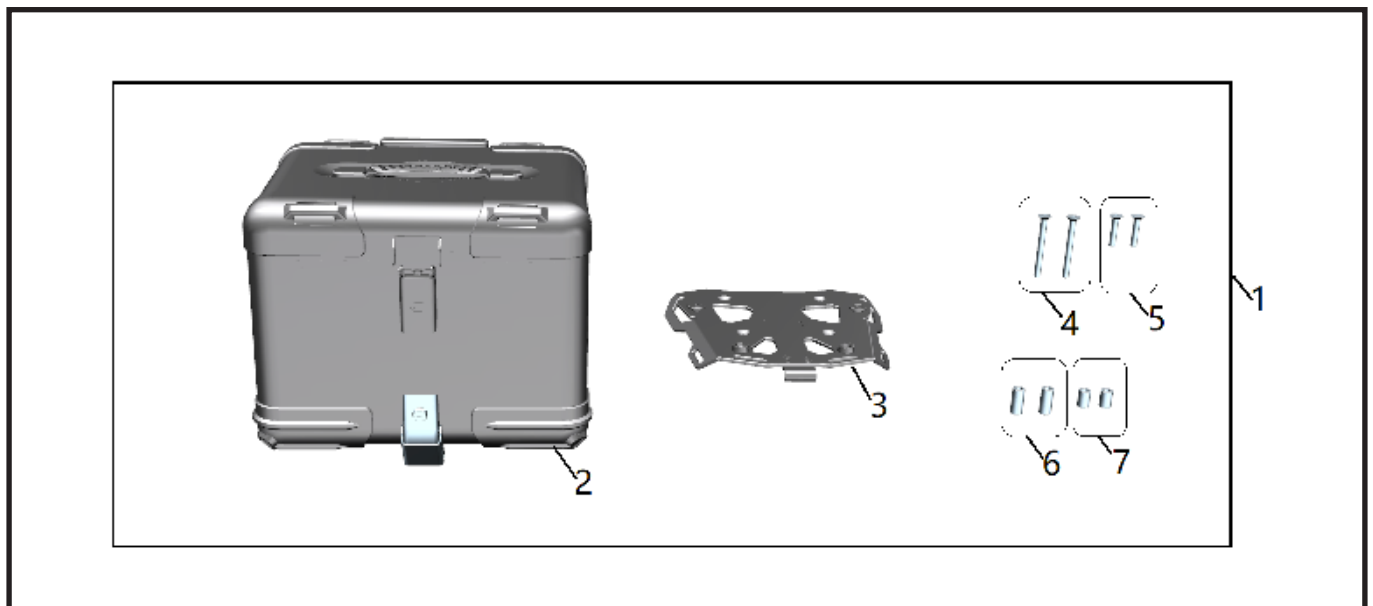

TOOL LIST:

ITEM	DESCRIPTION	QTY.	REMARK
1	PROTECTIVE GLOVES	1	Recommended tools
2	5mm ALLEN WRENCH	1	

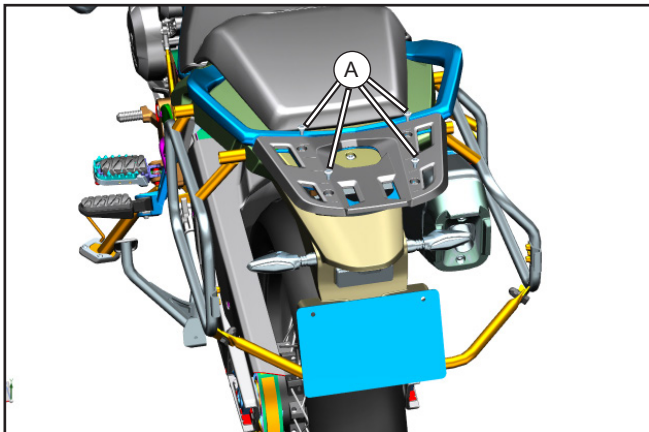

// Remove the bolts (A).

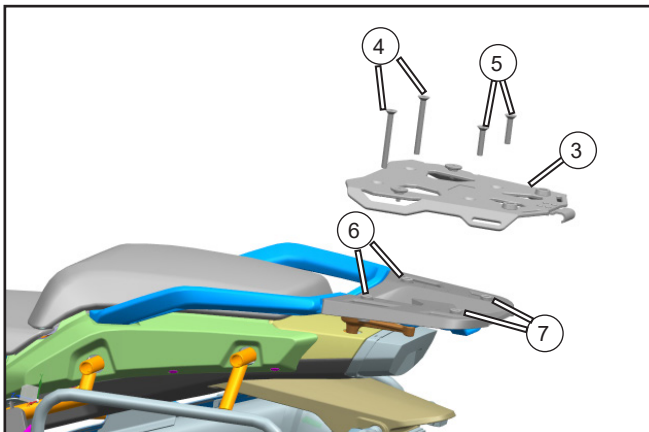

// Place the front supports (6) and the rear supports (7) into the assembly position. Install the tray (3) to the rear armrest cover with bolts (4,5). Torque the bolts evenly to specification.

i » Apply some thread locking sealant to the bolts.

BOLT(4)	M8×80	6WWV-803200-5000-20	16-21N.m
BOLT (5)	M8×40	6WWV-803200-5000-21	16-21N.m

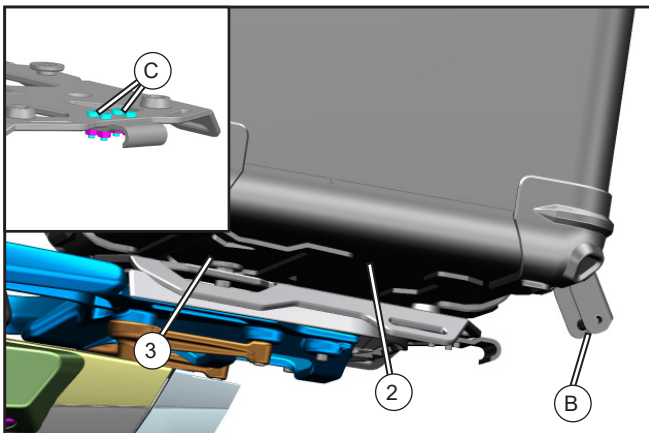

// Align the slots on the bottom of the tail box (2) with the protuberances on the tray (3) and push the tail box forward into the assembly position. Lock the latch (B).

i - Confirm the buckle is fully locked, you could loose the screw (C) then adjust the buckle position in case the side box is locked too tightly or too loosely. Make sure the screw (C) is fully installed after adjustment.

