

ACCESSORY SETUP INSTRUCTION

Brake Reservoir Guard, Rear -- PN 6WWV-802400-5000

VALID FOR: MY2023 and later Ibex 800 S, Ibex 800 T

BEFORE YOU BEGIN: Read and understand the instructions before starting any work. Make sure that all parts are ready and that you have all the tools required for assembly.

NOTE: CFMOTO shall not be liable for any damage caused by incorrect assembly. CFMOTO recommends that all original accessories be assembled by an authorized CFMOTO dealer.

Before assembly, park the vehicle on a flat surface, and turn off the key switch.

Zhejiang CFMOTO Power Co., Ltd. All rights reserved. Reproduction of this document, even in part, as well as copying of all kinds, is permitted only with the express written permission of the copyright owner.

MEANING OF SYMBOLS

 - Indicates information with more details or tips.

 - Indicates information of warning or danger.

PARTS LIST:

ITEM	PART NAME	PART NUMBER	QTY.	REMARK
1	GUARD, REAR FLUID RESERVOIR	6WWV-802400-5000	1	
2	GUARD, REAR FLUID RESERVOIR	6WWV-802401-5000	1	
3	BOLT	6WWV-802400-5000-20	1	

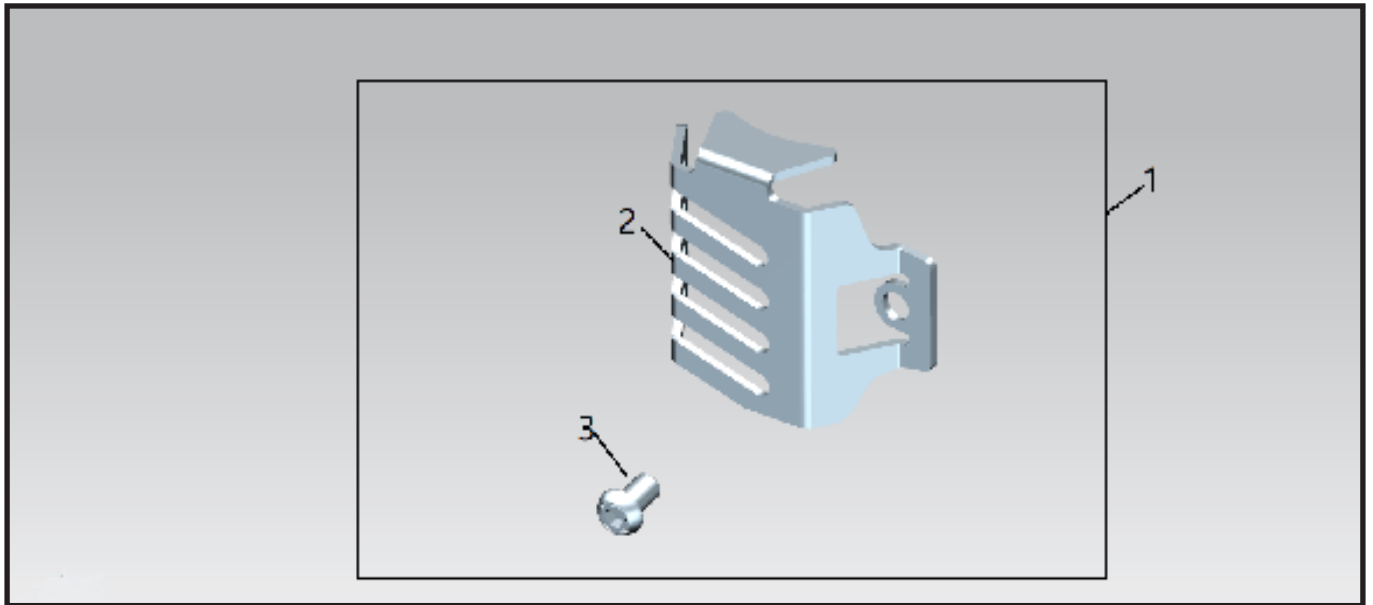

TOOL LIST:

ITEM	DESCRIPTION	QTY.	REMARK
1	4mm ALLEN WRENCH	1	Recommended tools
2	PROTECTIVE GLOVES	1	

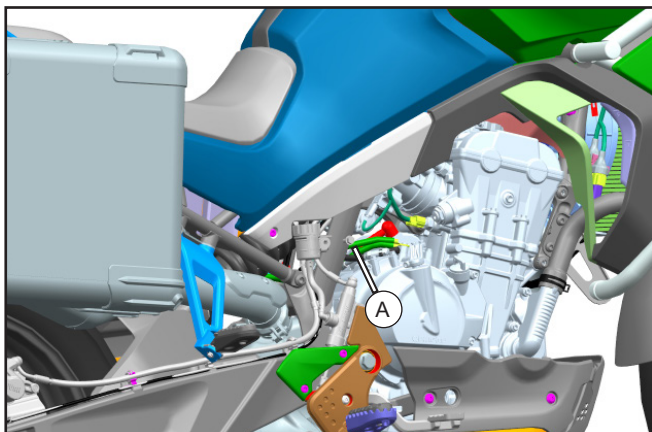

// Remove the rear fluid reservoir bolt (A).

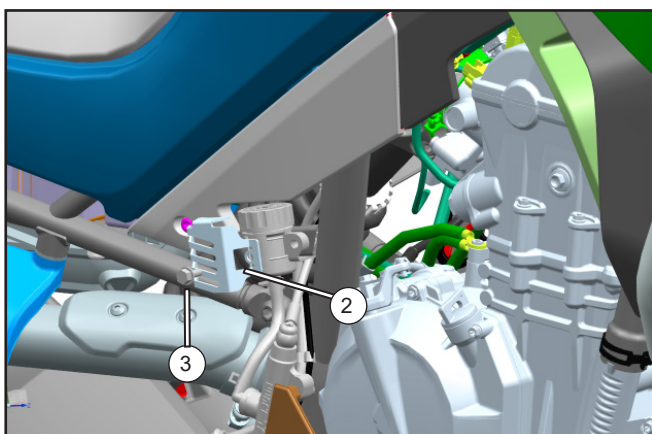

// Place the rear fluid reservoir guard (2) into the assembly position and install the bolt (3).

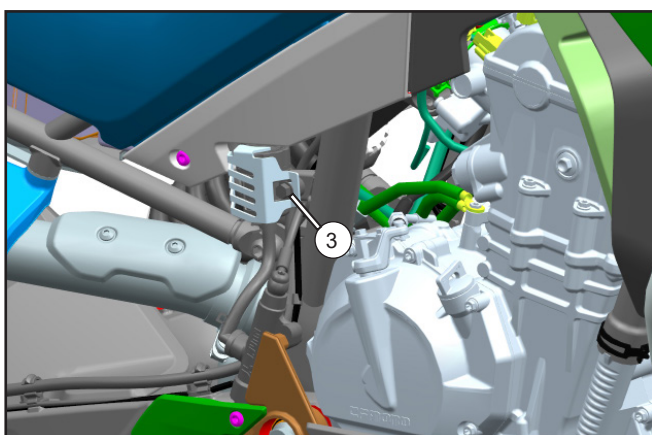

// Tighten the bolt (3).

i »Do not tighten the bolt by force to prevent the mounting hole from cracking.