

ACCESSORY SETUP INSTRUCTIONS

QUICKSHIFTER KIT PN: 6KWV-800200-1000

VALID FOR: MY2024 and later 800NK

BEFORE YOU BEGIN: Read and understand the instructions before starting any work. Make sure that all parts are ready and that you have all the tools required for assembly.

NOTE: CFMOTO shall not be liable for any damage caused by incorrect assembly. CFMOTO recommends that all original accessories be assembled by an authorized CFMOTO dealer.

Before assembly, park the vehicle on a flat surface and turn off the vehicle.

Zhejiang CFMOTO Power Co., Ltd. All rights reserved. Reproduction of this document, even in part, as well as copying of all kinds, is permitted only with the express written permission of the copyright owner.

MEANING OF SYMBOLS

 - Indicates information with more details or tips.

 - Indicates information of warning or danger.

PART LIST:

S/N	PART NAME	PART NUMBER	QTY.	DESCRIPTION
1	QUICKSHIFTER KIT	6KWV-800200-1000	1	Picture is for structure reference only.
2	MAGNET HOLDER	C90034050000	1	
3	SHIFT SHAFT SENSOR	C90034051100	1	
4	BOLT M5x12	C0984050123S	2	

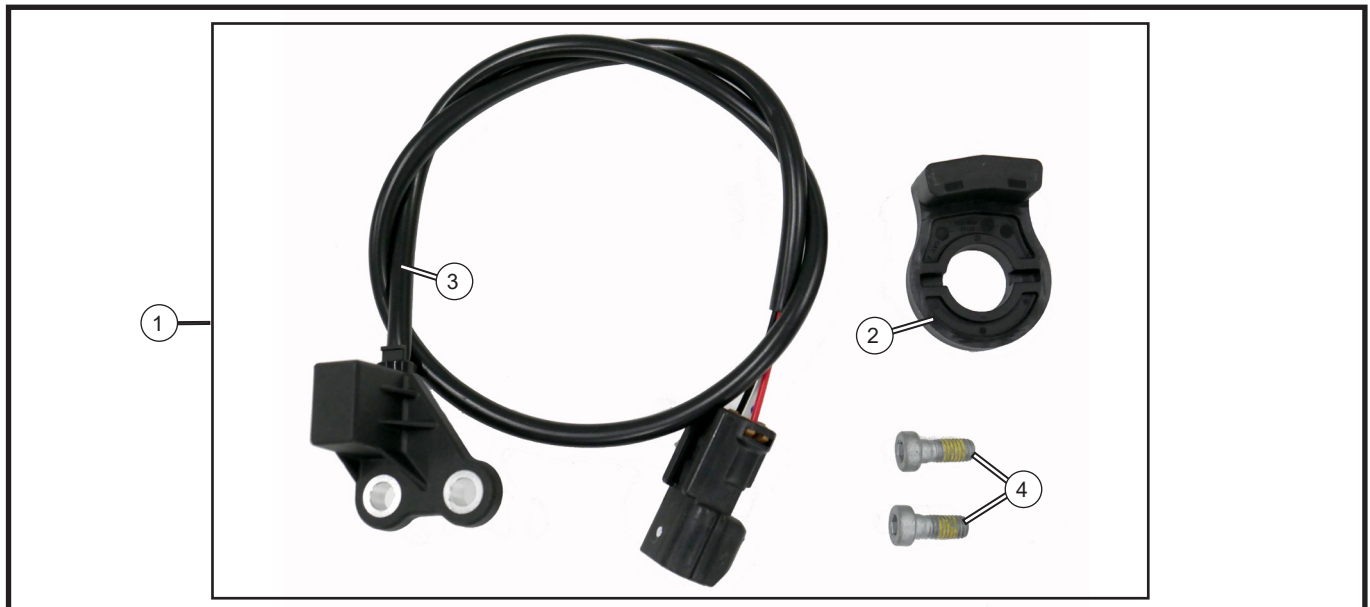

TOOL LIST:

ITEM	DESCRIPTION	REMARK
1	ZIP TIES	Recommended Tools
2	SOCKET WRENCH & 8mm SOCKET	
3	4mm & 5mm ALLEN WRENCHES	
4	TORQUE WRENCH & 4mm HEX BIT SOCKET	
5	SNAP RING PLIERS	
6	NEEDLE-NOSE PLIERS	
7	SNIPS	
8	PROTECTIVE GLOVES	

WORK



// Remove expansion rivets (B) and screws (C) for the left side deco plate (A).

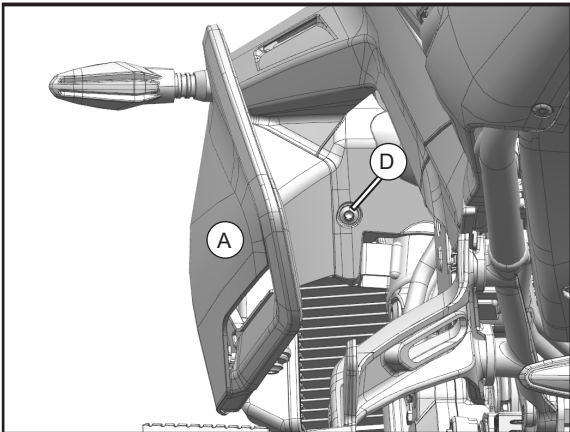

// Remove screw (D) for the left side deco plate (A).

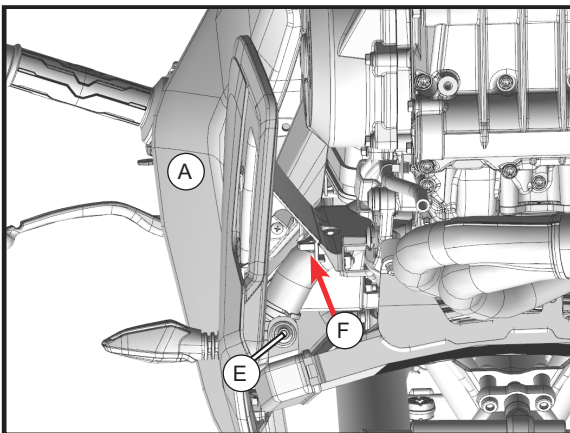

// Remove screw (E) for the left side deco plate (A).
// Release the clasp point (F).

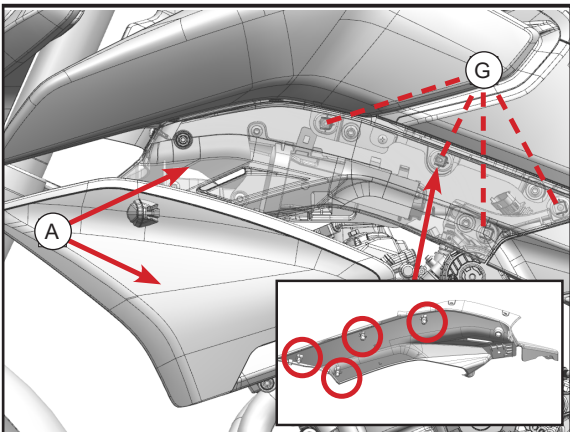

// Release the clasp points (G).
// Disconnect the wiring for the turn light.
// Remove the left side deco plate (A).

WORK

// Remove bolt for support cam (A). Then remove the cam.

i » Before removing the support cam, photograph or mark its position for future reference.

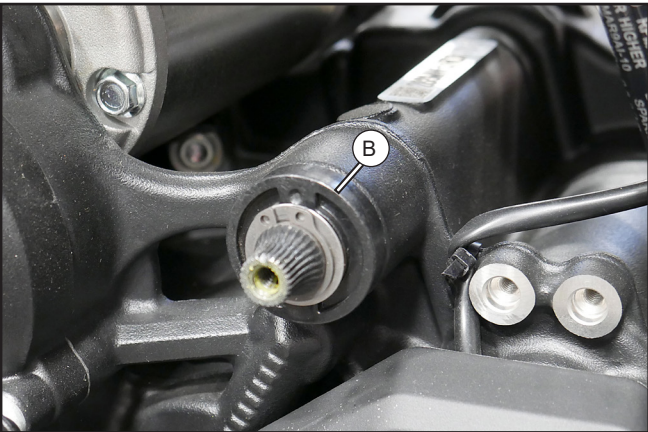

// Remove snap ring, shim and wave spring.
// Remove and discard spacer (B).

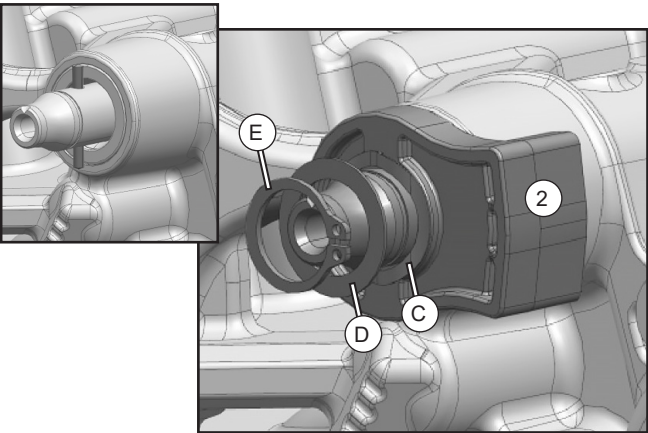

// Install magnet holder (2) onto the shift shaft.
// Install wave spring (C), shim (D) and snap ring (E) in the order shown.

i » Slotted side of the magnet holder must face the cross pin on the shift shaft.

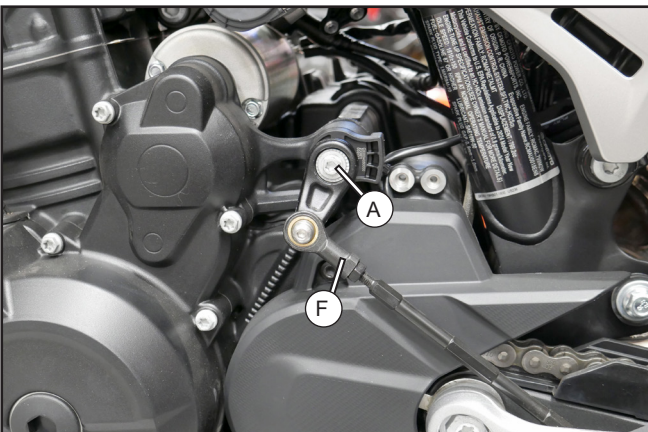

// Reinstall support cam and its bolt (A).
// Confirm the transmission can shift into each gear and the gearshift lever (F) is properly adjusted.

i » A photograph or mark made previously can help you correctly position the support cam.

WORK

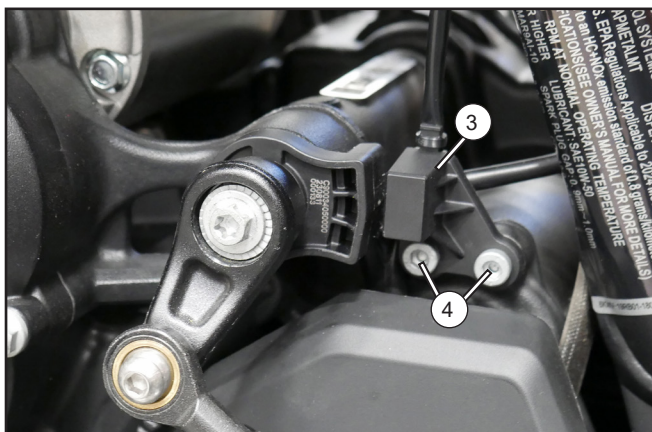

- // Install shift shaft sensor (3) onto the open mounts using the supplied bolts (4).
- // Torque bolts to specification.

BOLT (4)	M5×12	C0984050123S	6 N•m
----------	-------	--------------	-------



- // Free the vapor canister (A) from its normal position, and move it out of the way to the left.

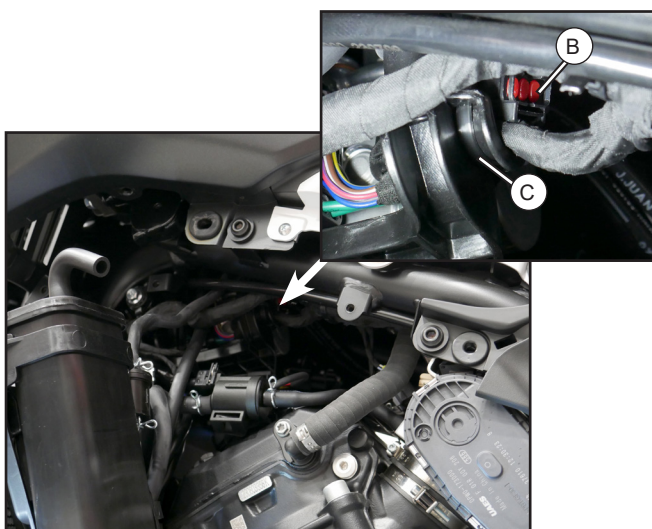

- // Locate the wiring harness connector (B) for the shift shaft sensor.
- // Free this connector by cutting and removing the nearby zip tie (C).
- // Remove and discard the dust cover on this connector.

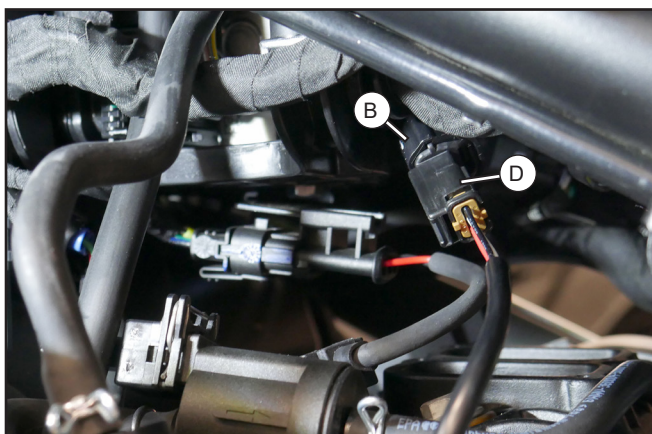

- // Route the wiring for the shift shaft sensor along the vehicle frame.
- // Connect the sensor plug (D) to the wiring harness connector (B).
- // Secure the sensor wiring with zip ties.

i » Two zip ties are required. One should replace the previously removed zip tie. Another should be located someplace that safely keeps the wiring along the vehicle frame.

WORK

// Return the vapor canister (A) to its normal position.

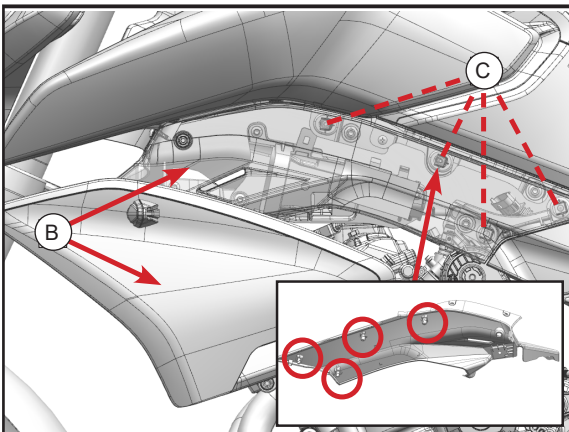

// Return the left side deco plate (B), and connect the wiring for the turn light.

// Secure the clasp points (C).

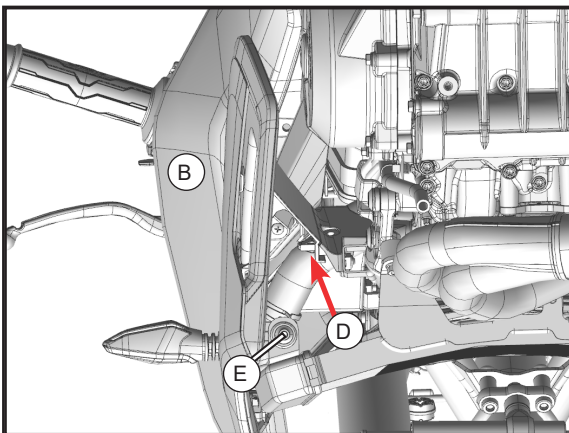

// Secure the clasp point (D).

// Reinstall screw (E) for the left side deco plate (B).

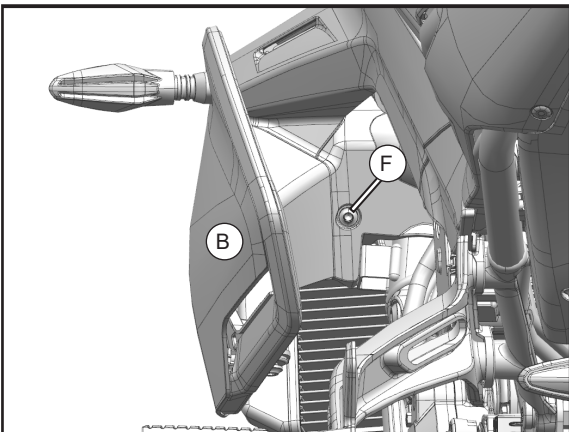

// Reinstall screw (F) for the left side deco plate (B).

WORK



// Reinstall expansion rivets (G) and screws (H) for the left side deco plate (B).



// Installation of kit is complete.