

ACCESSORY SETUP INSTRUCTION

RADIATOR GUARD ASSY -- PN 6GUV-803000-6000

VALID FOR: MY2020 and Newer 700 CL-X Motorcycles

BEFORE YOU BEGIN: Read and understand the instructions before starting any work. Make sure that all parts are ready and that you have all the tools required for assembly.

NOTE: CFMOTO shall not be liable for any damage caused by incorrect assembly. CFMOTO recommends that all original accessories be assembled by an authorized CFMOTO dealer.

Before assembly, park the vehicle on a flat surface, put the transmission gear into Park (P) and turn off the key switch.

Zhejiang CFMOTO Power Co., Ltd. All rights reserved. Reproduction of this document, even in part, as well as copying of all kinds, is permitted only with the express written permission of the copyright owner.

MEANING OF SYMBOLS



- Indicates information with more details or tips.



- Indicates information of warning or danger.

PARTS LIST:

| ITEM | PART NAME | PART NUMBER | QTY. | REMARK |
|------|---------------------|---------------------|------|---------------------------------------|
| 1 | RADIATOR GUARD ASSY | 6GUV-803000-6000 | 1 | The picture is not the final product. |
| 2 | RADIATOR GUARD | 6GUV-803010-6000 | 1 | |
| 3 | LOWER BRACKET,LH | 6GUV-803003-6000 | 1 | |
| 4 | LOWER BRACKET,RH | 6GUV-803004-6000 | 1 | |
| 5 | SCREW M5×10 | 6GUV-801700-6000-20 | 2 | |
| 6 | NUT M5 | 6GUV-801700-6000-24 | 2 | |

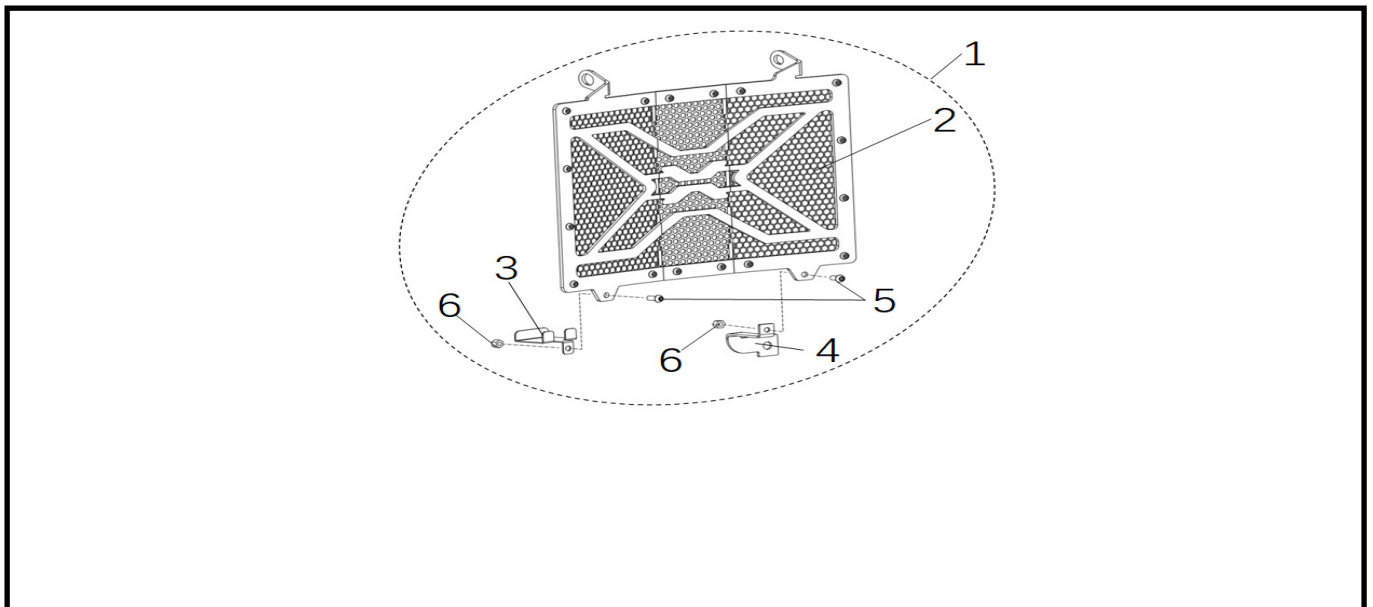

TOOL LIST:

| Item | Description | QTY. | REMARK |
|------|------------------------|------|-------------------|
| 1 | PROTECTIVE GLOVES | 1 | Recommended tools |
| 2 | 8-10mm OPEN END WRENCH | 1 | |
| 3 | 13mm SOCKET | 1 | |
| 4 | 4mm ALLEN WRENCH | 1 | |

ASSEMBLY and INSTALLATION

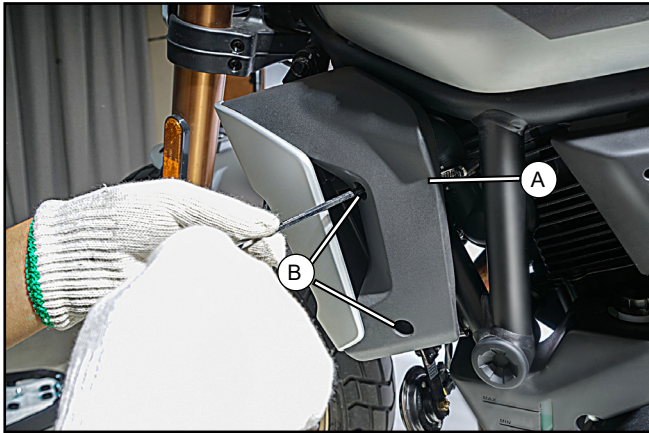

// Loosen the screws (B) and remove the radiator protector (A).



// Pull out the plug (A).



// Remove the radiator mounting bolt (A).

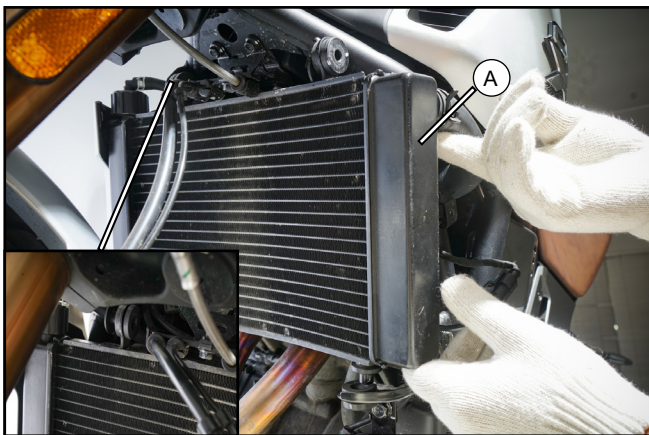

// Lift up the radiator (A), and then pull it in the opposite direction of the upper mounting point to reserve the installation position.

ASSEMBLY and INSTALLATION

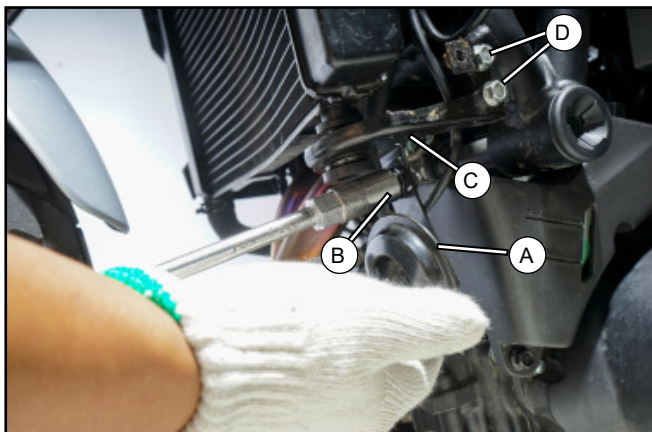

- // Loosen the bolt (B) and remove the horn (A).
- // Loosen the bolt (D) and remove the radiator bracket(C).

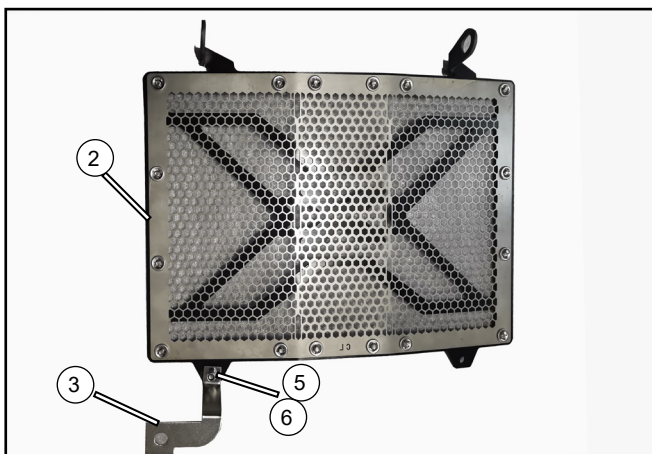

- // Install the lower left bracket (3) to the radiator guard (2) with screws (5) and nuts (6). Do not tighten them at this time.

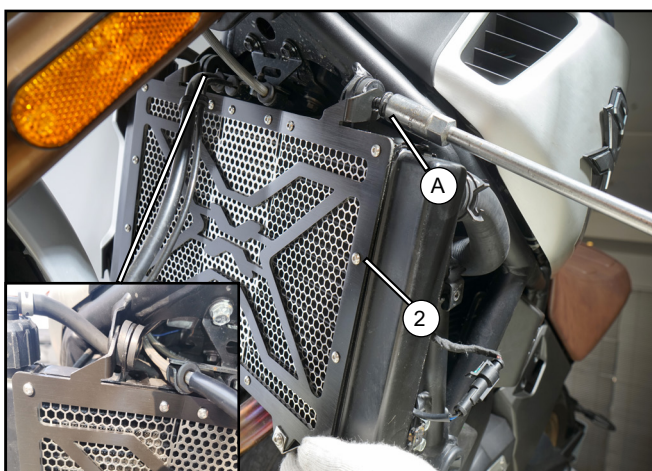

- // Install the radiator guard (2) to the radiator with bolt (A).

| | | | |
|------|-------|-----------------|----------|
| BOLT | M8x30 | 30006-080030870 | 14-21N.m |
|------|-------|-----------------|----------|

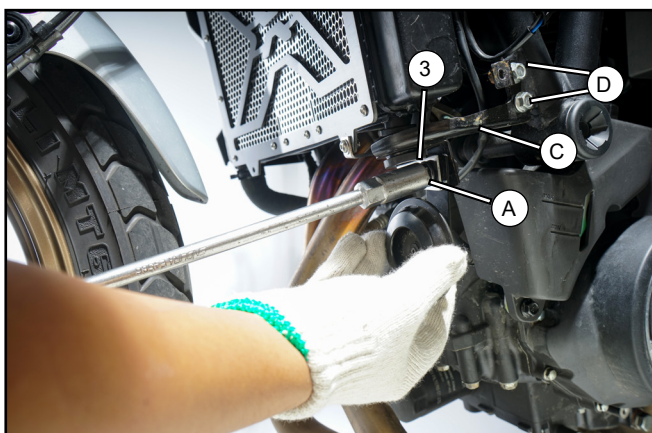

- // Install the radiator bracket(C) and pre tighten bolts(D)
- // Place the left lower bracket (3) in the assembly position, put on the horn and align with the mounting hole, then tighten the bolt (A.D).

i » NOTE: Bracket is placed on top of the horn.

ASSEMBLY and INSTALLATION

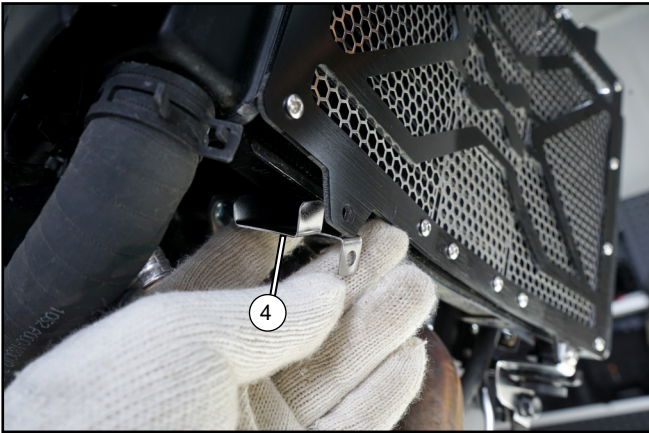

// Place the right lower bracket (4) in the assembly position.

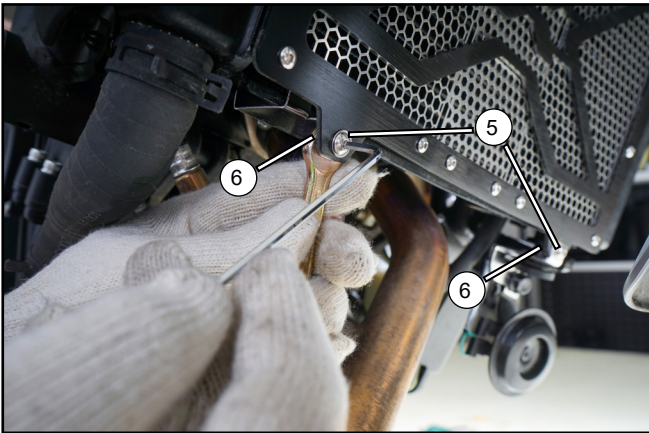

// Install screws (5) and nuts (6) and tighten.

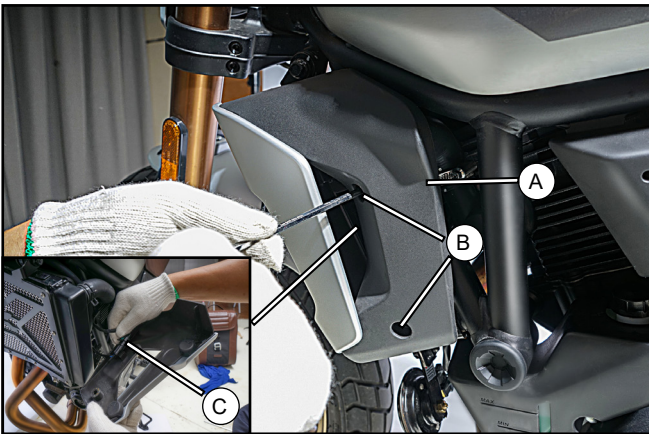

// Connect the plug C.
// Install radiator protector (A) with the screws (B)