

ACCESSORY SETUP INSTRUCTION

SIED STAND SEAT -- PN 6GUV-802100-6000

VALID FOR: MY2020 and Newer 700 CL-X Motorcycles

BEFORE YOU BEGIN: Read and understand the instructions before starting any work. Make sure that all parts are ready and that you have all the tools required for assembly.

NOTE: CFMOTO shall not be liable for any damage caused by incorrect assembly. CFMOTO recommends that all original accessories be assembled by an authorized CFMOTO dealer.

Before assembly, park the vehicle on a flat surface, put the transmission gear into Park (P) and turn off the key switch.

Zhejiang CFMOTO Power Co., Ltd. All rights reserved. Reproduction of this document, even in part, as well as copying of all kinds, is permitted only with the express written permission of the copyright owner.

MEANING OF SYMBOLS

 - Indicates information with more details or tips.

 - Indicates information of warning or danger.

PARTS LIST:

ITEM	PART NAME	PART NUMBER	QTY.	REMARK
1	SIED STAND SEAT	6GUV-802100-6000	1	The picture is not the final product.
2	LOWER BASE	6GUV-802101-6000	1	
3	UPPER COVER	6GUV-802102-6000	1	
4	SCREW M6x10	6GUV-802100-6000-20	3	

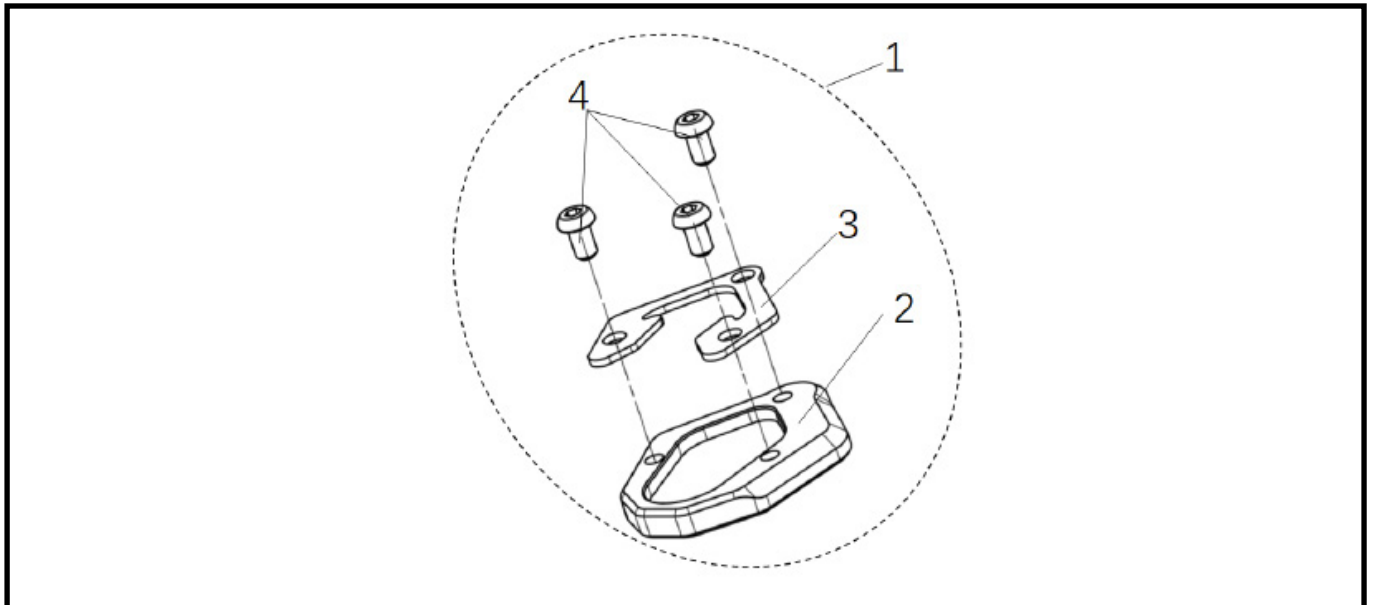

TOOL LIST:

Item	Description	QTY.	REMARK
1	PROTECTIVE GLOVES	1	Recommended tools
2	4mm ALLEN WRENCH	1	

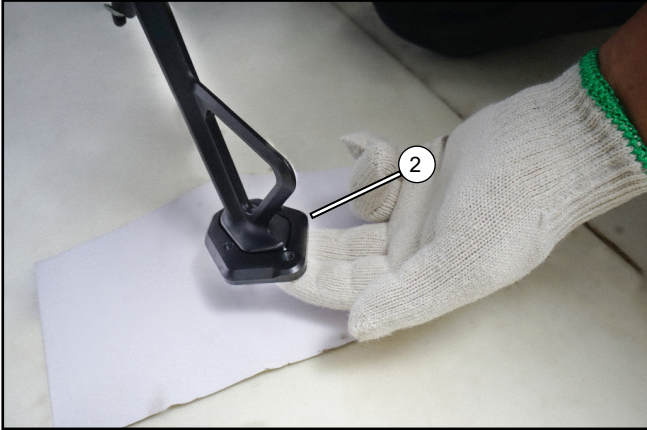

// Place the lower base (2) in the installation position.

i Use the front wheel stand assembly to hold up the motorcycle.

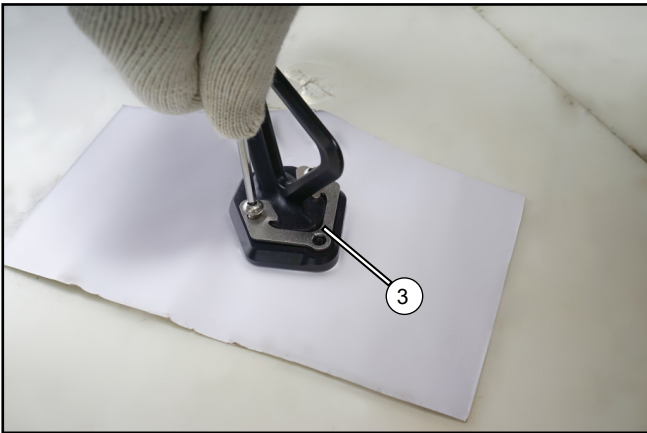

// Place the upper cover (3) in the installation position.

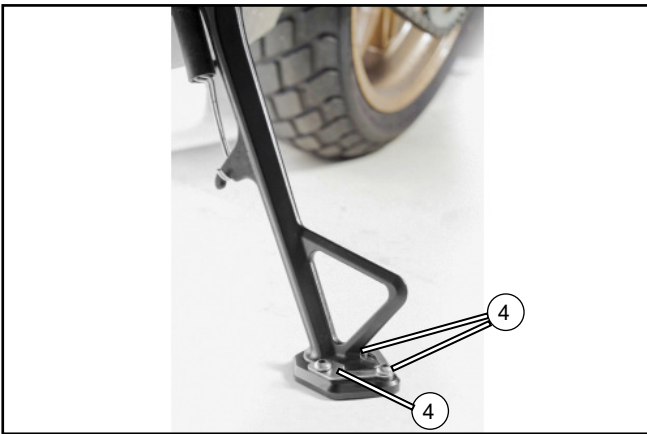

// Install and tighten the screws (4).