

## ACCESSORY SETUP INSTRUCTIONS

### AXLE SLIDER, REAR PN: 6AQV-802500-1000

VALID FOR: CF 450SR/SS

**BEFORE YOU BEGIN:** Read and understand the instructions before starting any work. Make sure that all parts are ready and that you have all the tools required for assembly.

**NOTE:** CFMOTO shall not be liable for any damage caused by incorrect assembly. CFMOTO recommends that all original accessories be assembled by an authorized CFMOTO dealer.

Before assembly, park the vehicle on a flat surface and turn off the vehicle.

**Zhejiang CFMOTO Power Co., Ltd.** All rights reserved. Reproduction of this document, even in part, as well as copying of all kinds, is permitted only with the express written permission of the copyright owner.

### MEANING OF SYMBOLS

 - Indicates information with more details or tips.

 - Indicates information of warning or danger.

### PART LIST:

S/N	PART NAME	PART NUMBER	QTY.	DESCRIPTION
1	AXLE SLIDER, REAR	6AQV-802500-1000	1	Picture is for structure reference only.
2	SHAFT, REAR AXLE SLIDER	6AQV-802501-1000	1	
3	HINCH BALL	6AQV-802402-1000	1	
4	NUT M6	6AQV-802400-1000-20	2	

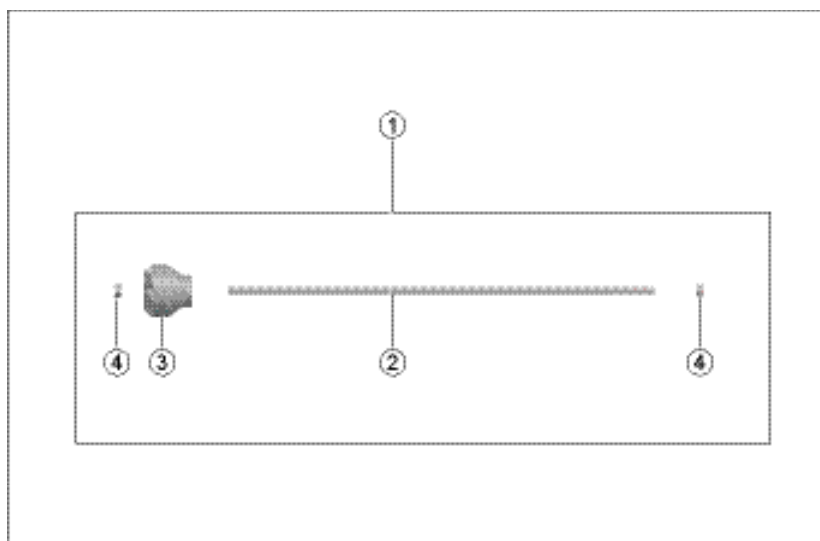

### TOOL LIST:

ITEM	DESCRIPTION	REMARK
1	10mm T-SOCKET WRENCH	Recommended Tools
2	PROTECTIVE GLOVES	

## WORK

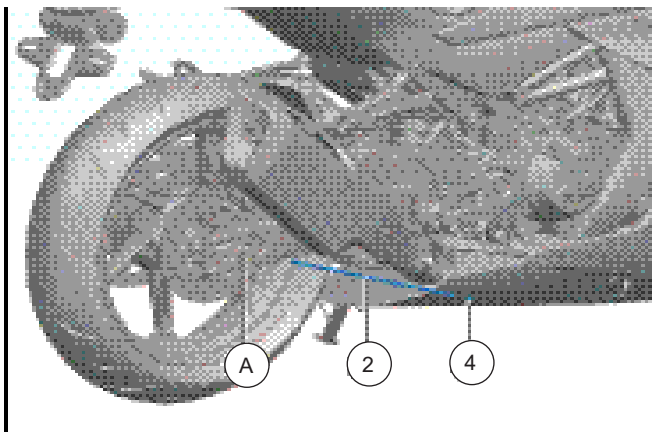

- // Install a M6 nut (4) on the shorter-thread side of the rear axle slider shaft (2).
- // Install this slider shaft assembly through the rear wheel shaft (A) from the exhaust pipe side.

**i** - Apply medium-strength threadlocker on shaft threads.

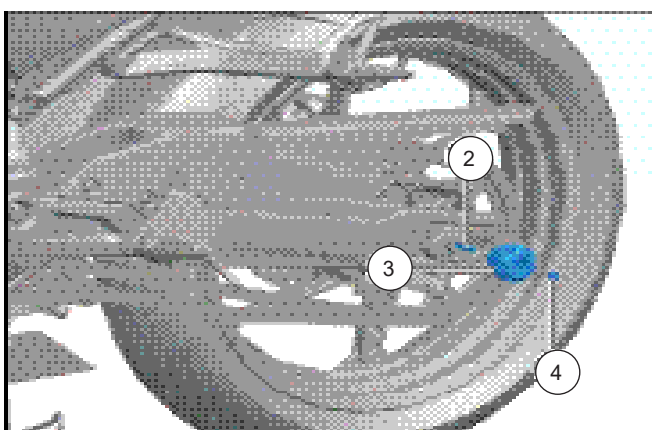

- // Put the hinch ball (3) on the other side of the rear axle slider shaft (2), and secure it with a M6 nut (4).
- // Tighten the M6 nuts (4) on both sides.

**i** - Apply medium-strength threadlocker on shaft threads.

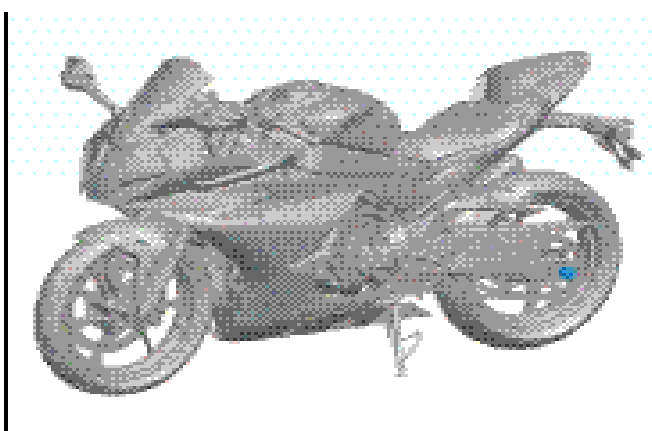

- // Assembly is complete.