

ACCESSORY SETUP INSTRUCTION

REAR BUMPER ASSEMBLY -- PN 5HY#-801200-1000

VALID FOR: MY2020 and Newer UFORCE 1000 UTVs

BEFORE YOU BEGIN: Read and understand the instructions before starting any work. Make sure that all parts are ready and that you have all the tools required for assembly.

NOTE: CFMOTO shall not be liable for any damage caused by incorrect assembly. CFMOTO recommends that all original accessories be assembled by an authorized CFMOTO dealer.

Before assembly, park the vehicle on a flat surface, put the transmission gear into Park (P) and turn off the key switch.

Zhejiang CFMOTO Power Co., Ltd. All rights reserved. Reproduction of this document, even in part, as well as copying of all kinds, is permitted only with the express written permission of the copyright owner.

MEANING OF SYMBOLS

 - Indicates information with more details or tips.

 - Indicates information of warning or danger.

PARTS LIST:

| ITEM | PART NAME | PART NUMBER | QTY. | REMARK |
|------|----------------------|------------------|------|--------|
| 1 | REAR BUMPER ASSEMBLY | 5HY#-801200-1000 | 1 | |
| 2 | REAR BUMPER | 5HY#-801210-1000 | 1 | |
| 3 | BOLT M8×25 | 30006-080025870 | 2 | |
| 4 | PLUG 38 | 9DS#-801401-6000 | 2 | |

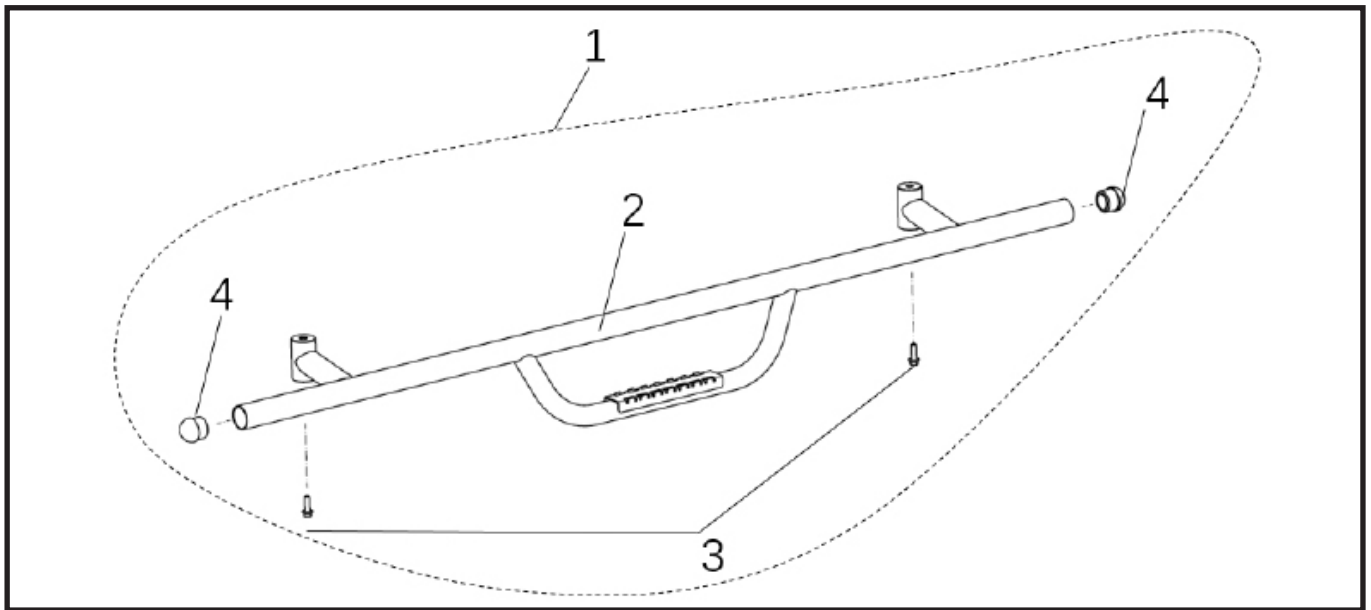

TOOL LIST:

| ITEM | DESCRIPTION | QTY. | REMARK |
|------|----------------------|------|-------------------|
| 1 | 13mm T-SOCKET WRENCH | 1 | Recommended tools |
| 2 | RUBBER HAMMER | 1 | |
| 3 | PROTECTIVE GLOVES | 1 | |

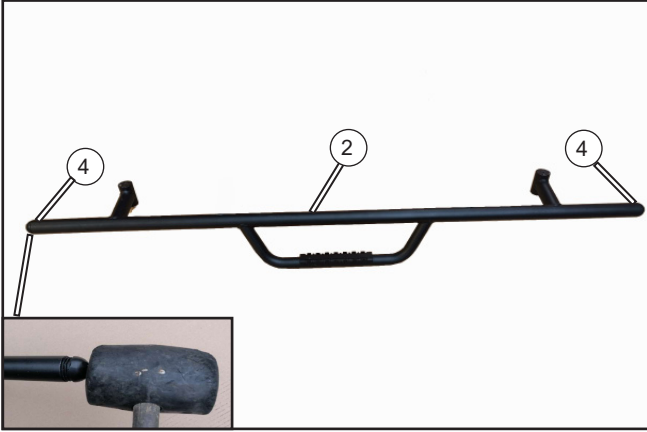

// Use a rubber hammer to install the plugs (4) into the rear bumper (6).

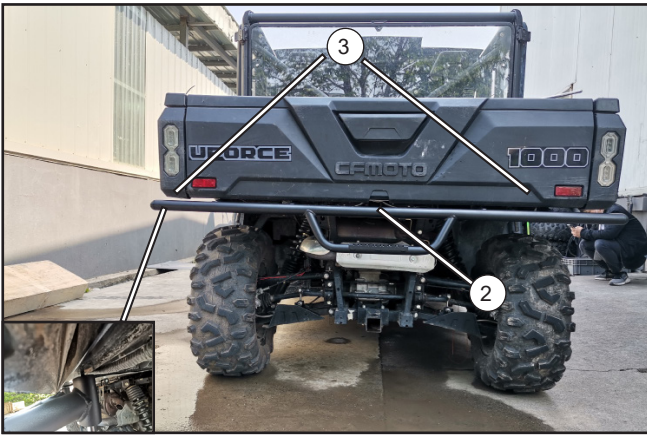

// Position the rear bumper (2) in the assembly position as shown, then install bolts (3).

// Torque the bolts evenly to specification.

| | | | |
|------|-------|-----------------|----------|
| BOLT | M8×25 | 30006-080025870 | 15-26N.m |
|------|-------|-----------------|----------|