

# ACCESSORY SETUP INSTRUCTION

## LOWER DOOR INSERTS ASSEMBLY 5BY#-807000-1000 / (RH) PN 5BY#-807400-1000

VALID FOR: MY2020 ZFORCE 950 SPORT & ZFORCE 1000 SPORT

**BEFORE YOU BEGIN:** Read and understand the instructions before starting any work. Make sure that all parts are ready and that you have all the tools required for assembly.

**NOTE:** CFMOTO shall not be liable for any damage caused by incorrect assembly. CFMOTO recommends that all original accessories be assembled by an authorized CFMOTO dealer.

Before assembly, park the vehicle on a flat surface, put the transmission gear into Park (P) and turn off the key switch.

**Zhejiang CFMOTO Power Co., Ltd.** All rights reserved. Reproduction of this document, even in part, as well as copying of all kinds, is permitted only with the express written permission of the copyright owner.

### MEANING OF SYMBOLS

 - Indicates information with more details or tips.

 - Indicates information of warning or danger.

### PARTS LIST:

ITEM	PART NAME	PART NUMBER	QTY.	REMARK
1	LOWER DOOR INSERT, RH	5BY#-807401-1000	1	
2	DOOR INSERT PANEL, RH	5BY#-807402-1000	1	
3	DOOR WELDING BRACKET ASSY, RH	5BY#-807410-1000	1	
4	PLASTIC CLIPS	9060-040310	5	
5	INNER HEX SCREW M6x12	6KM6-040702-8000	5	
6	BOLT M8X16	30006-080016870	3	
7	NUT CLIP M6	8030-040800	5	
8	SEALING STRIP	5BY#-807303-1000	1	
9	LOWER DOOR INSERTS ASSEMBLY (RH)	5BY#-807400-1000	1	

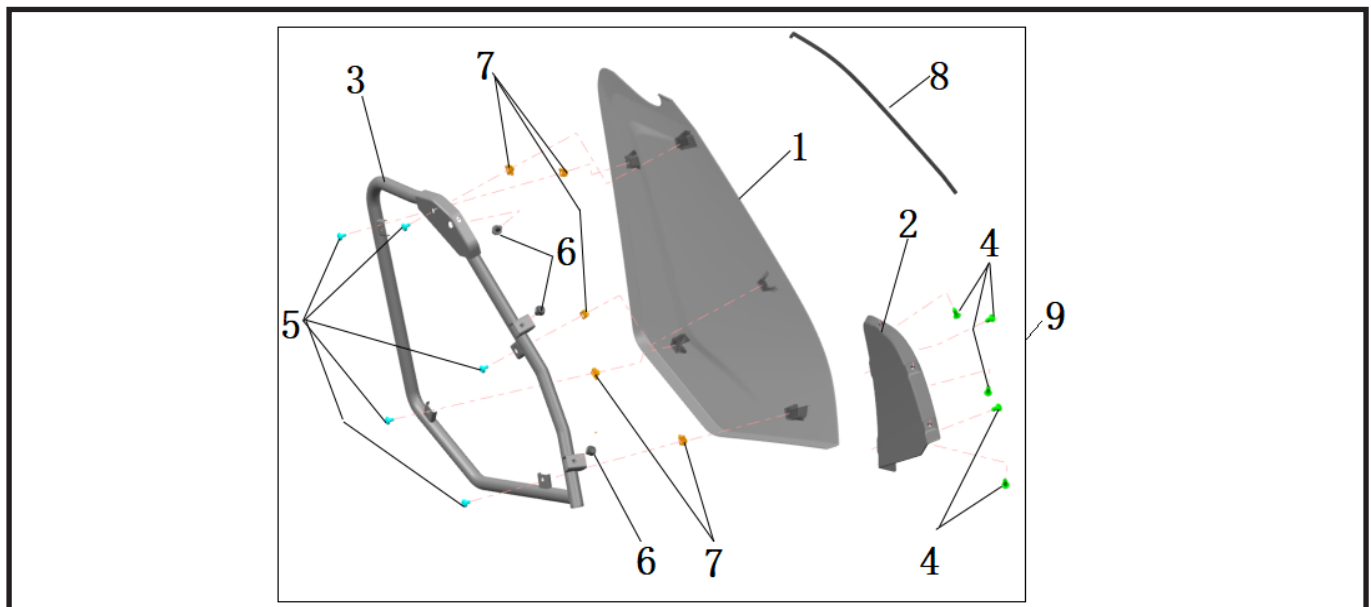

### TOOL LIST:

ITEM	DESCRIPTION	QTY.	REMARK
1	PHILIPS SCREWDRIVER	1	Recommended tools
2	4mm ALLEN WRENCH	1	
3	SOCKET WRENCH 13mm	1	
4	TORQUE WRENCH	1	
5	8.5mm TWIST DRILL	1	
6	PROTECTIVE GLOVES	1	

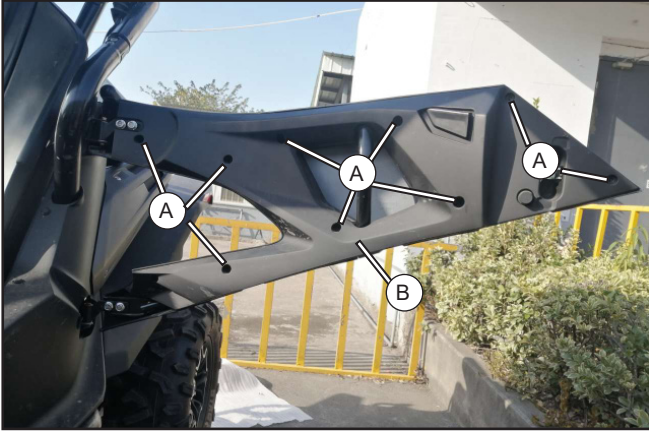

// Remove bolts (A) and passenger side inner door panel (B).

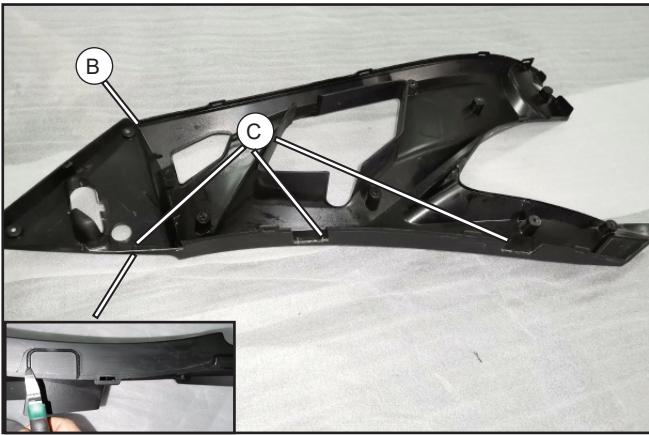

// Trim rectangle pieces (C) from the inner door panel (B) as shown, following the lines molded into the panel.

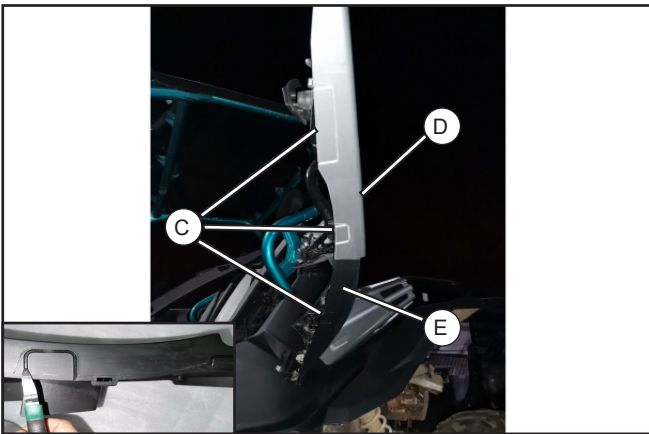

// Trim rectangle pieces (C) from the outer door deco panel (D) and outer door rear panel (E) as shown, following the lines molded into the panel.

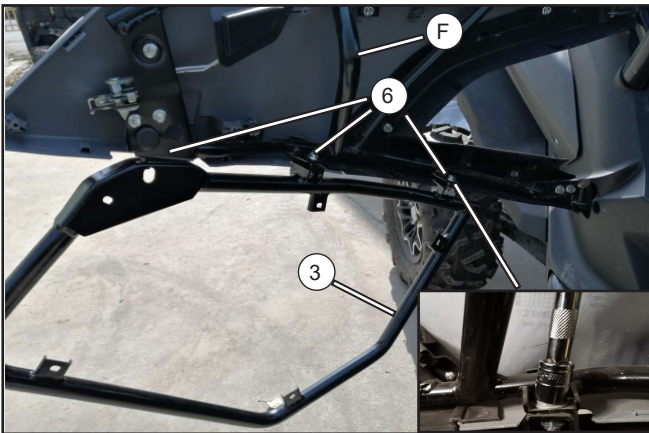

// Attach the right door bracket (3) to the right door frame (F) using bolts (6). Torque the fasteners to specification.

BOLT	M8X16	30006-080016870	15-23N.m
------	-------	-----------------	----------

## ASSEMBLY and INSTALLATION

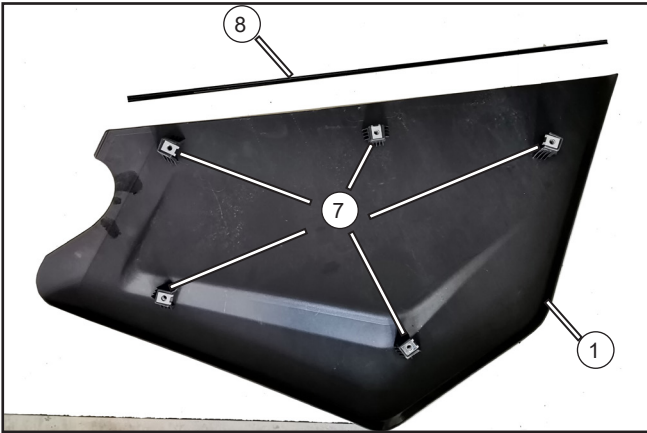

// Install nut clips (7) and sealing strip (8) to the right lower door insert (1).



// Fasten the right lower door insert (1) to the bracket (3) using inner hex screws (5). Torque the fasteners to specification.

INNER HEX SCREW	M6X12	6KM6-040702-8000	8-10N.m
-----------------	-------	------------------	---------



// Drill holes in the rear right side door panel opening according to the molded hole trace marks (G) as shown.

**i** The specification of drill bit is 8.5mm.

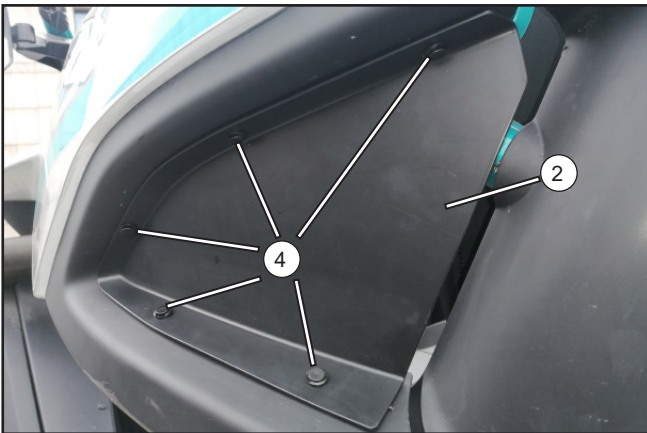

// Install the right door insert panel (2) in the right side door rear panel opening and secure it with plastic clips (4).

## ACCESSORY SETUP INSTRUCTION

### LOWER DOOR INSERTS ASSEMBLY 5BY#-807000-1000 / (LH) PN 5BY#-807300-1000

VALID FOR: MY2020 ZFORCE 950 & ZFORCE 1000 SPORT

**BEFORE YOU BEGIN:** Read and understand the instructions before starting any work. Make sure that all parts are ready and that you have all the tools required for assembly.

**NOTE:** CFMOTO shall not be liable for any damage caused by incorrect assembly. CFMOTO recommends that all original accessories be assembled by an authorized CFMOTO dealer.

Before assembly, park the vehicle on a flat surface, put the transmission gear into Park (P) and turn off the key switch.

**Zhejiang CFMOTO Power Co., Ltd.** All rights reserved. Reproduction of this document, even in part, as well as copying of all kinds, is permitted only with the express written permission of the copyright owner.

## MEANING OF SYMBOLS

 - Indicates information with more details or tips.

 - Indicates information of warning or danger.

## PARTS LIST:

ITEM	PART NAME	PART NUMBER	QTY.	REMARK
1	LOWER DOOR INSERT, LH	5BY#-807301-1000	1	
2	DOOR INSERT PANEL, LH	5BY#-807302-1000	1	
3	DOOR WELDING BRACKET ASSY, LH	5BY#-807310-1000	1	
4	PLASTIC CLIPS	9060-040310	5	
5	INNER HEX SCREW M6x12	6KM6-040702-8000	5	
6	BOLT M8X16	30006-080016870	3	
7	NUT CLIP M6	8030-040800	5	
8	SEALING STRIP	5BY#-807303-1000	1	
9	LOWER DOOR INSERTS ASSEMBLY (LH)	5BY#-807300-1000	1	

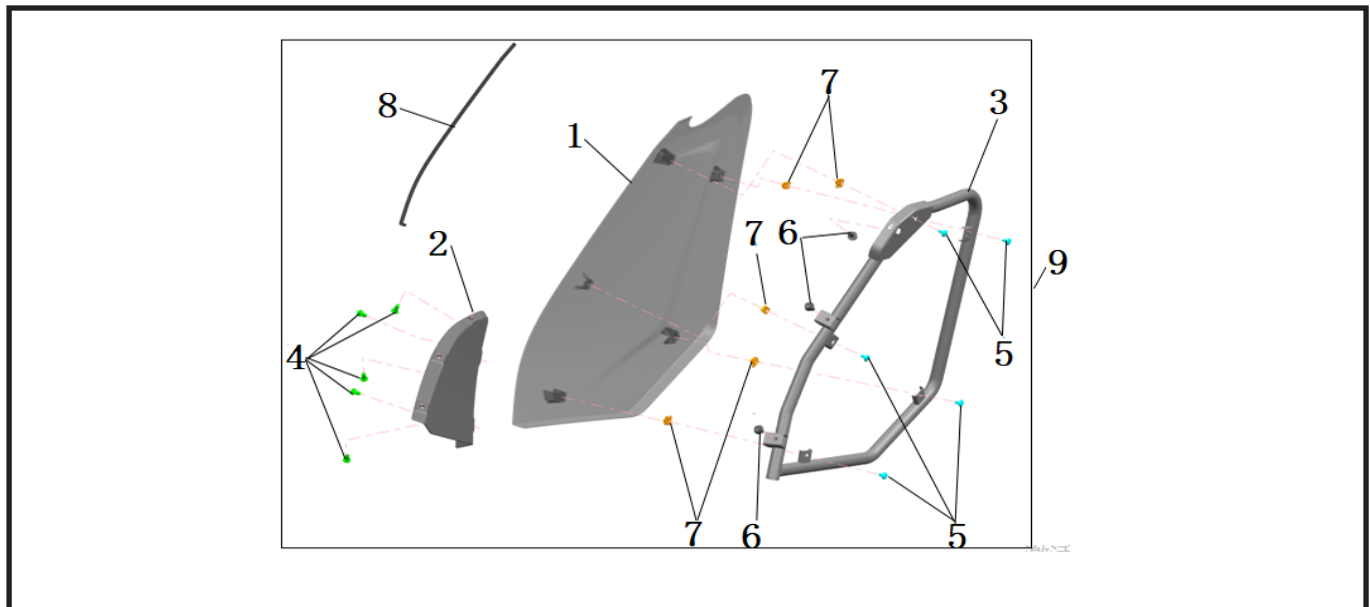

## TOOL LIST:

ITEM	DESCRIPTION	QTY.	REMARK
1	PHILIPS SCREWDRIVER	1	Recommended tools
2	4mm ALLEN WRENCH	1	
3	SOCKET WRENCH 13mm	1	
4	TORQUE WRENCH	1	
5	8.5mm TWIST DRILL	1	
6	PROTECTIVE GLOVES	1	

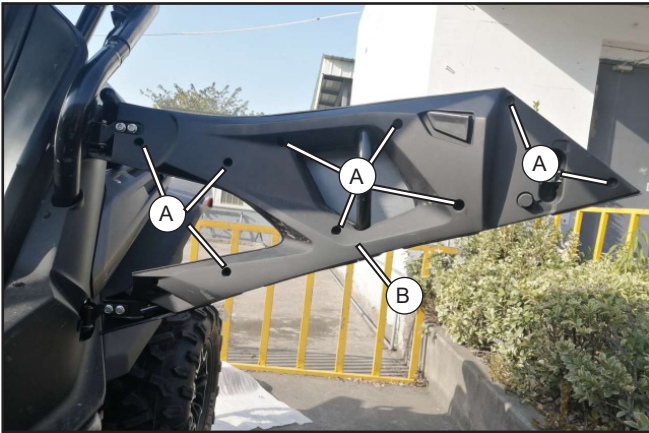

// Remove bolts (A) and driver side inner door panel (B).

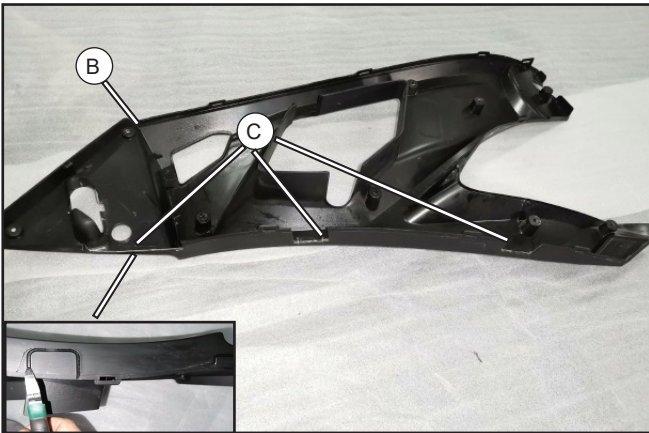

// Trim rectangle pieces (C) from the inner door panel (B) as shown, following the lines molded into the panel.

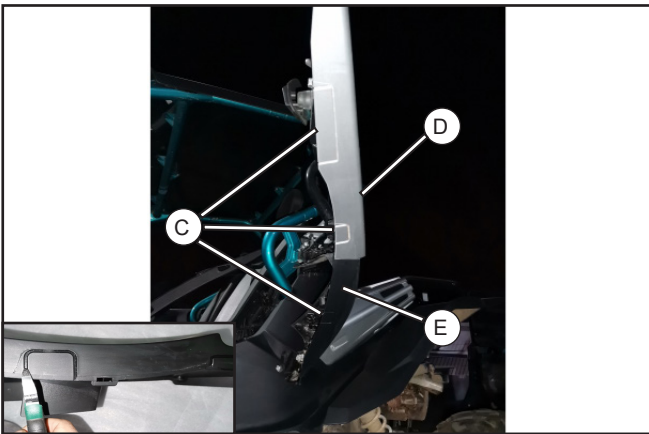

// Trim rectangle pieces (C) from the outer door deco panel (D) and outer door rear panel (E) as shown, following the lines molded into the panel.

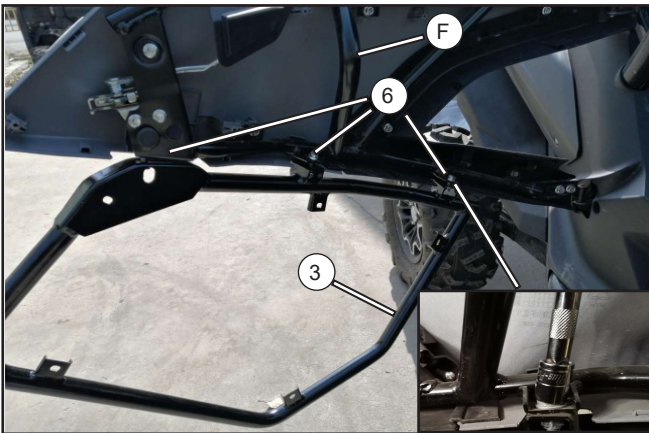

// Attach the left door bracket (3) to the door frame (F) using bolts (6). Torque the fasteners to specification.

BOLT	M8X16	30006-080016870	15-23N.m
------	-------	-----------------	----------

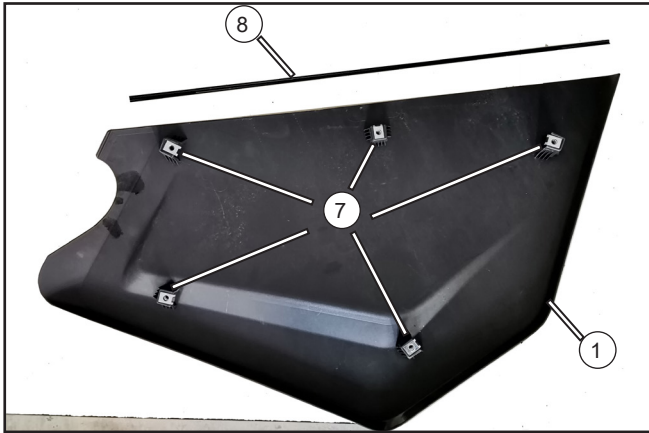

// Install nut clips (7) and sealing strip (8) to the left lower door insert (1).



// Fasten the left lower door insert (1) to the bracket (3) using inner hex screws (5). Torque the fasteners to specification.

INNER HEX SCREW	M6X12	6KM6-040702-8000	8-10N.m
-----------------	-------	------------------	---------



// Drill holes in the rear left side door panel opening according to the molded hole trace marks (G) as shown.

**i** The specification of drill bit is 8.5mm.

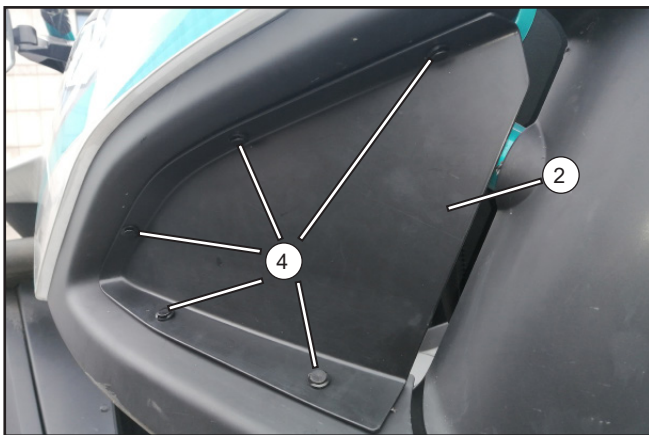

// Install the left door insert panel (2) in the left side door rear panel opening and secure it with plastic clips (4).