

ACCESSORY SETUP INSTRUCTION

REAR BUMPER ASSEMBLY -- PN 5BY#-801200-1000

VALID FOR: MY2020 ZFORCE 950 & ZFORCE 1000

BEFORE YOU BEGIN: Read and understand the instructions before starting any work. Make sure that all parts are ready and that you have all the tools required for assembly.

NOTE: CFMOTO shall not be liable for any damage caused by incorrect assembly. CFMOTO recommends that all original accessories be assembled by an authorized CFMOTO dealer.

Before assembly, park the vehicle on a flat surface, put the transmission gear into Park (P) and turn off the key switch.

Zhejiang CFMOTO Power Co., Ltd. All rights reserved. Reproduction of this document, even in part, as well as copying of all kinds, is permitted only with the express written permission of the copyright owner.

MEANING OF SYMBOLS

 - Indicates information with more details or tips.

 - Indicates information of warning or danger.

PARTS LIST:

ITEM	PART NAME	PART NUMBER	QTY.	REMARK
1	REAR BUMPER ASSY	5BY#-801210-1000	1	
2	CLAMP 42	5BY#-801220-1000	1	
3	PLUG 38	9DS#-801200-6000-20	4	
4	INNER HEX SCREW M10×30	5BY#-801100-1000-21	2	
5	INNER HEX SCREW M8×20	5BY#-801201-1000	2	
6	REAR BUMPER ASSEMBLY	5BY#-801200-1000	1	

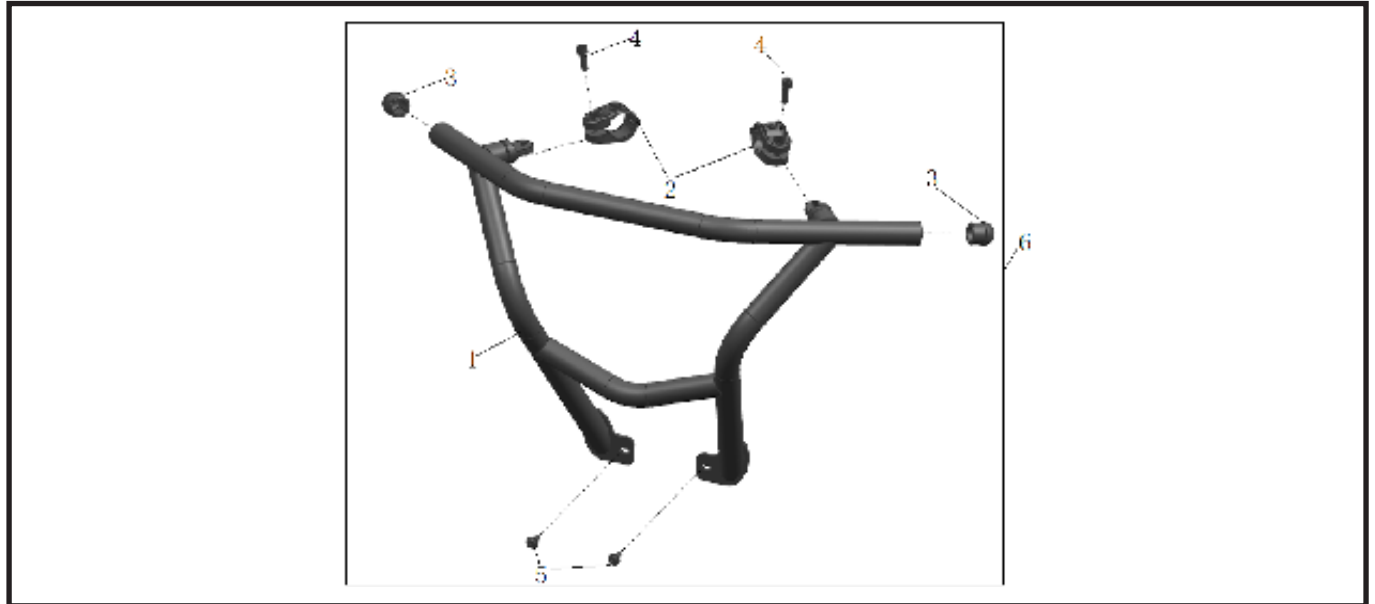

TOOL LIST:

ITEM	DESCRIPTION	QTY.	REMARK
1	5mm HEX BIT SOCKET	1	Recommended tools
2	TORQUE WRENCH	1	
3	PROTECTIVE GLOVES	1	
4	RUBBER HAMMER	1	

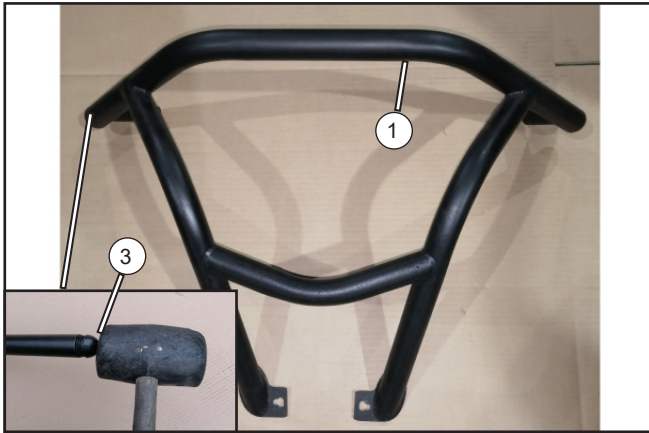

// Use a rubber hammer (3) to install the plugs (3) into the rear bumper (1).



// Position the bumper assembly (1) on the rear of the vehicle as shown, then insert inner hex screws (5) but do not tighten at this time.

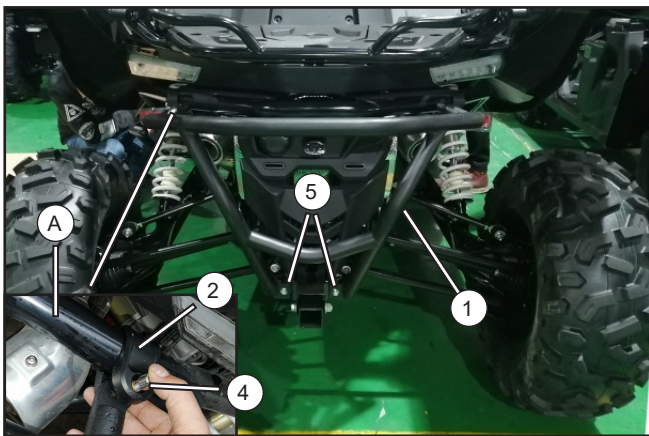

// Install the clamps (2) around the vehicle rear bumper (A), then secure the bumper assembly (1) with inner hex screws (4).

// Torque the inner hex screws (4) and (5) evenly to specification.

- i** » Ensure that the rear bumper assembly (1) is installed in the correct position.
- » Torque the bolts (5) in the previous step evenly to specification.

INNER HEX SCREW	M10×30	5BY#-801100-1000-21	35-45N.m
INNER HEX SCREW	M8×20	5BY#-801201-1000	15-23N.m