

## ACCESSORY SETUP INSTRUCTION

### FRONT BUMPER ASSEMBLY -- PN 5AS#-801100-6000

VALID FOR: MY2021 and Newer UFORCE 600

**BEFORE YOU BEGIN:** Read and understand the instructions before starting any work. Make sure that all parts are ready and that you have all the tools required for assembly.

**NOTE:** CFMOTO shall not be liable for any damage caused by incorrect assembly. CFMOTO recommends that all original accessories be assembled by an authorized CFMOTO dealer.

Before assembly, park the vehicle on a flat surface, put the transmission gear into Park (P) and turn off the key switch.

**Zhejiang CFMOTO Power Co., Ltd.** All rights reserved. Reproduction of this document, even in part, as well as copying of all kinds, is permitted only with the express written permission of the copyright owner.

### MEANING OF SYMBOLS

 - Indicates information with more details or tips.

 - Indicates information of warning or danger.

### PARTS LIST:

ITEM	PART NAME	PART NUMBER	QTY.	REMARK
1	FRONT BUMPER ASSEMBLY	5AS#-801100-6000	1	
2	FRONT BUMPER	5AS#-801110-6000	1	
3	PLUG 38	9DS#-801401-6000	2	
4	BOLT M10×1.25×45	30006-102045810	2	

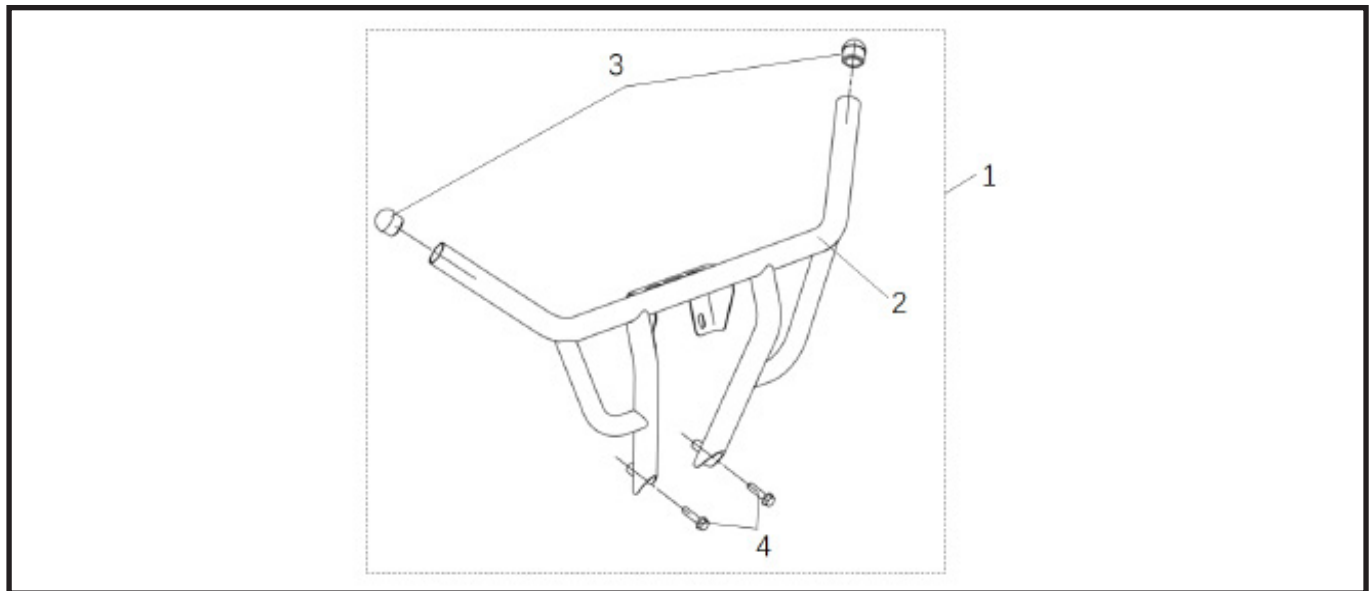

### TOOL LIST:

ITEM	DESCRIPTION	QTY.	REMARK
1	15mm SOCKET	1	Recommended tools
2	13mm SOCKET	1	
3	RUBBER HAMMER	1	
4	PROTECTIVE GLOVES	1	

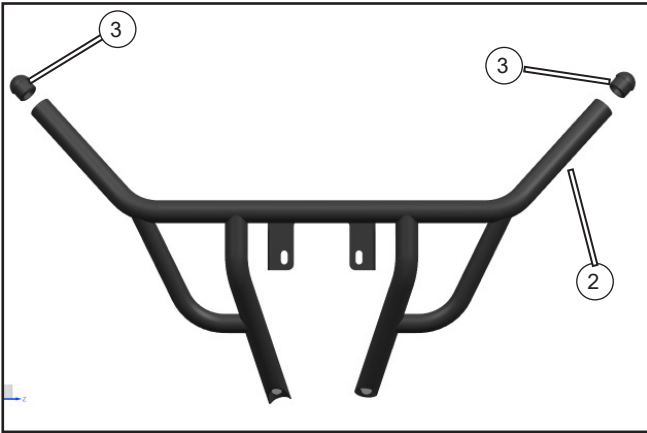
**ASSEMBLY and INSTALLATION**

// Use a rubber hammer to install the plugs (3) into the front bumper (2).



// Turn on the main key switch, then press and hold the winch 'OUT' button to let out the winch rope approximately 20cm.

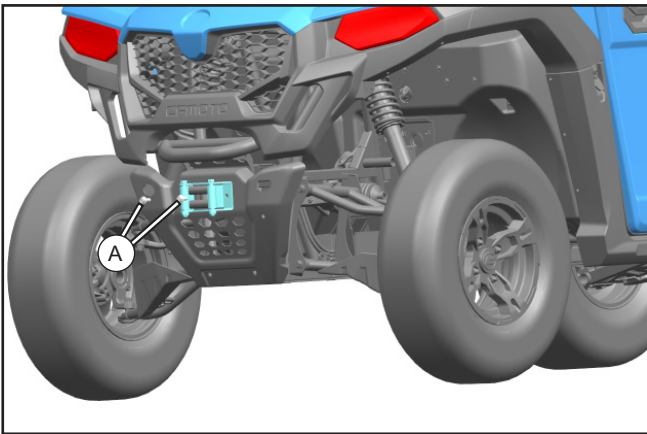

// Remove the winch fairlead bolts (A).

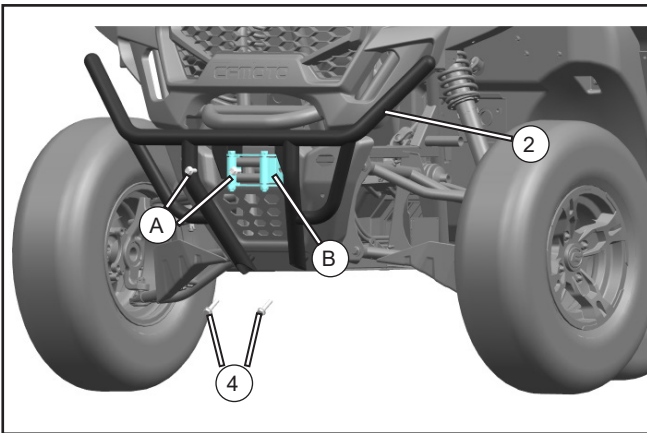

// Align the winch fairlead and upper bumper mount to the mounting holes, then install the previously removed bolts (A). *Do not fully tighten bolts at this time.*

// Install the lower mount bolts (4), then tighten all bolts to the specified torque value.

// Retract the winch rope when installation is complete.

**i** **NOTE: Winch fairlead is placed on top of the bumper.**

BOLT (A)	M10	/	70-80N.m
BOLT (4)	M10×1.25×45	30006-102045810	70-80N.m